

# The Future of Australian Logistics





# Overview

No other logistics precinct in Australia compares to the scale and location of Moorebank Intermodal.

243 ha  
Prime logistics and intermodal precinct

1,200,000sqm  
Onsite large format warehousing

1,550,000 TEU  
A year across the IMEX and Interstate Terminals





20+ MW  
Of rooftop solar across the estate





# Strategic Location

The location is minutes to Sydney's arterial road network via M5 and M7. The site has benefits further from both Interstate and Import Export (IMEX) Intermodal terminals.

-  0 km to M5
-  5 km to M7
-  25 km to Sydney Airport 32
-  km to Port Botany
-  32 km to Western Sydney Airport

## Legend

-  Rail Link to IMEX
-  Motorways

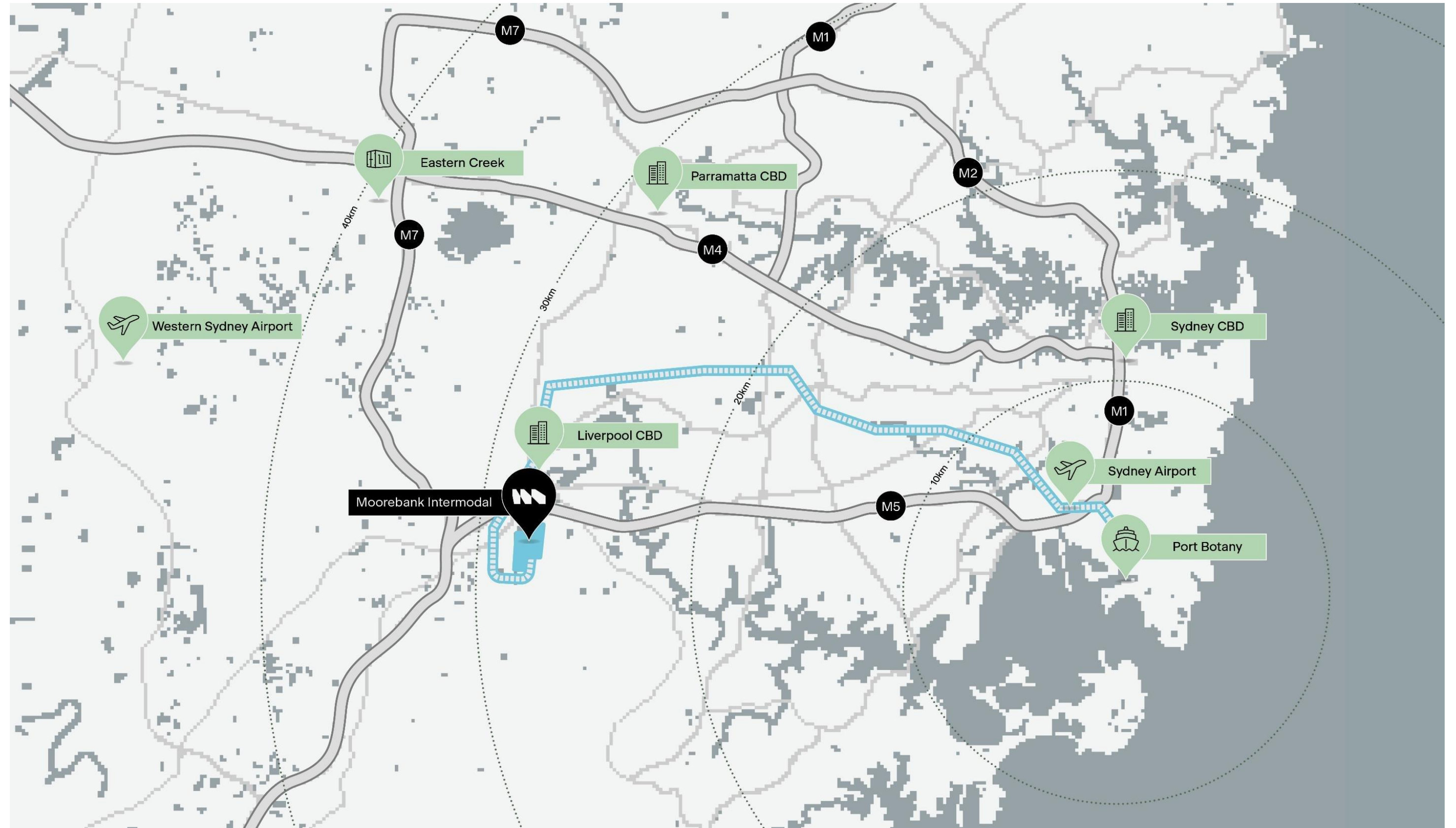

# Connecting to Australia's inland rail network

Moorebank Intermodal Precinct will connect via the Interstate Terminal to the Inland Rail network, allowing a direct link to Melbourne, Adelaide, Perth and Parkes. This network will enhance our nations freight and supply chain capabilities, connecting existing freight routes through rail, road and ports.

Inland Rail means freight can be delivered faster and more reliably across Australia and beyond to global markets.

## Legend

-  Rail Link to IMEX
-  Motorways





# Interstate Terminal

The Moorebank Interstate Rail Terminal was officially opened in April 2024.

The terminal will process 1,800m long interstate trains, each moving approximately 1,500 tonnes of freight and consumer goods. The terminal will ultimately be able to process circa. 3,000 trains per year with an expected capacity of 500,000 TEU per year.

The terminal’s efficiency benefits will result in significantly lower supply chain costs and lower transport emissions.

Owned & Operated by The Moorebank Intermodal Terminal Company, a joint venture of ESR, National Intermodal, and Qube Logistics.

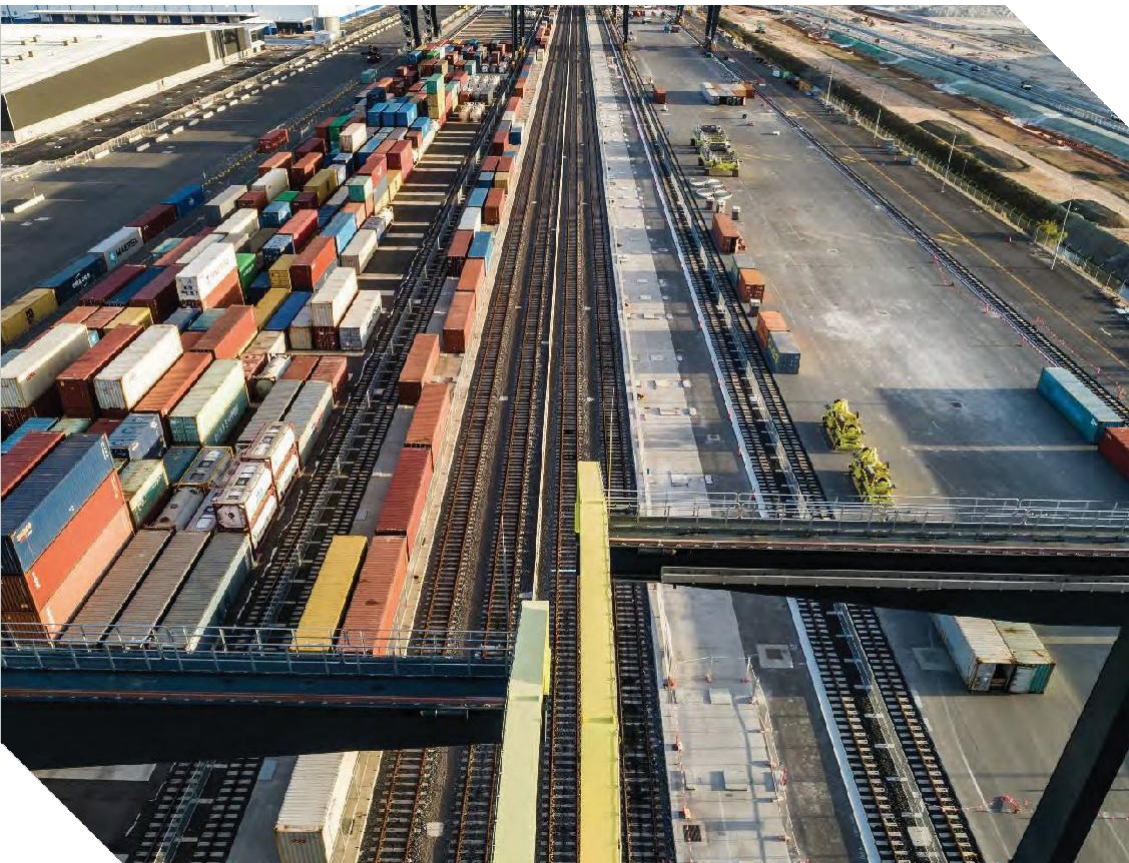
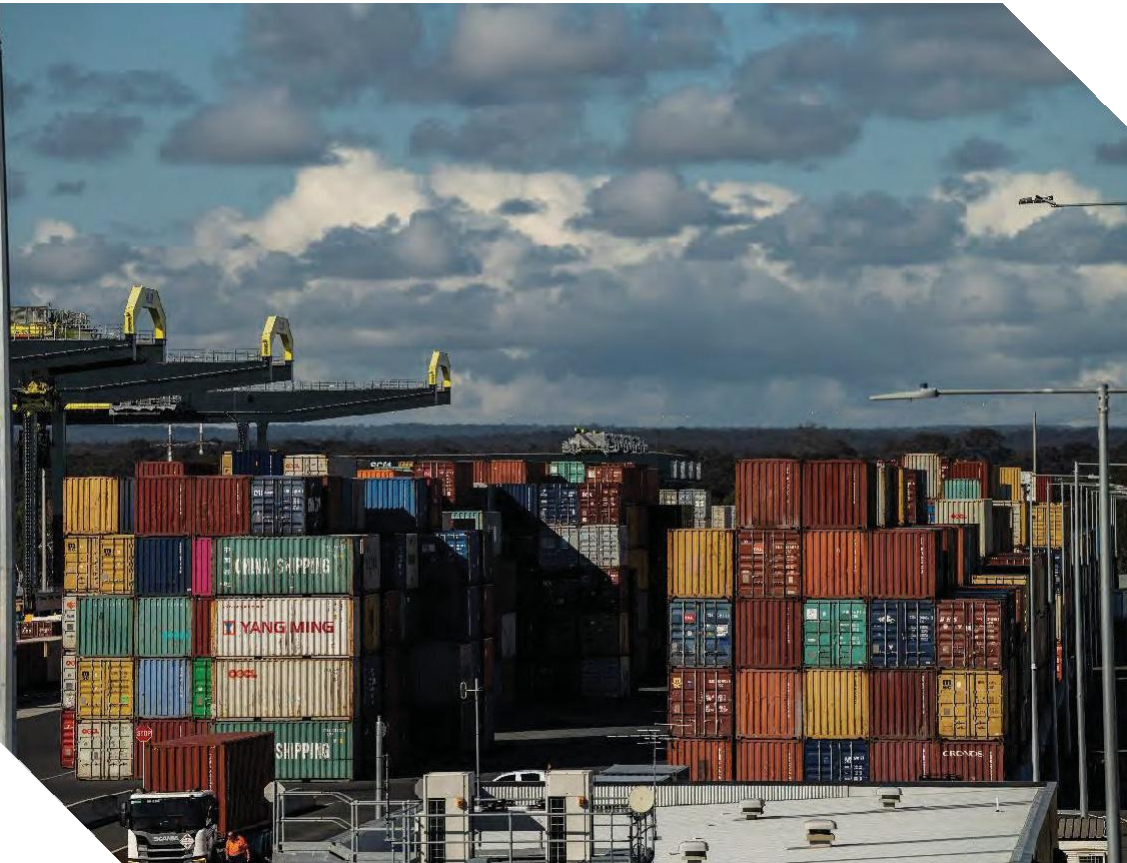



# Masterplan

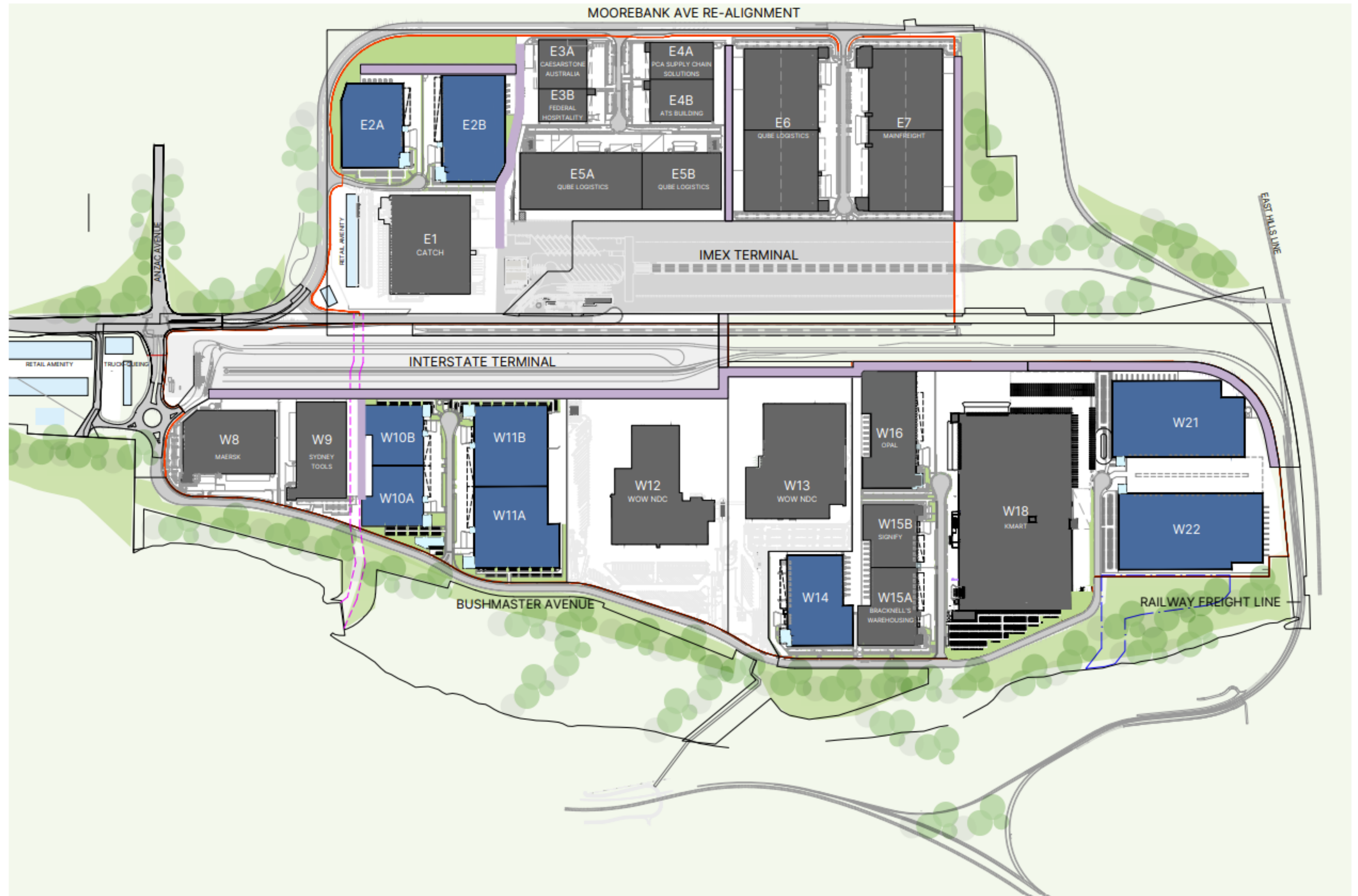



1 

2 

3 

4 

5 

6 

7 

8 

9 

10 

11 

12 

13  

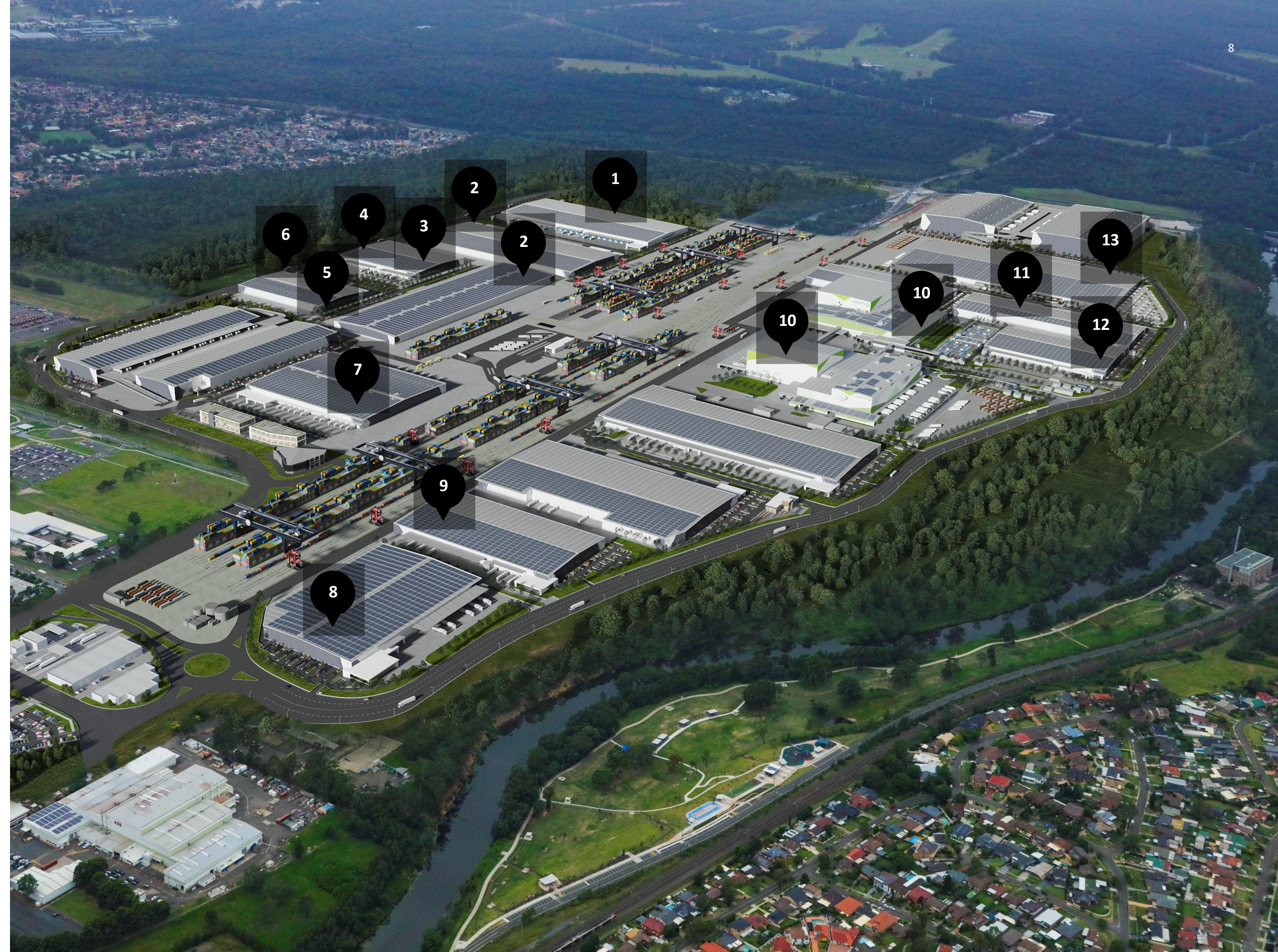



# Unbridled Supply Chain Benefits



Reduced  
delivery timing



Supply chain  
savings shifting  
from road to rail



Reduced  
carbon footprint  
accelerating  
Net Zero targets



Savings on  
outgoings

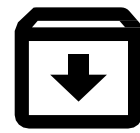

Fast turn-  
around for  
inventory stock  
levels



Total  
savings on  
interstate  
transport



Electricity  
savings

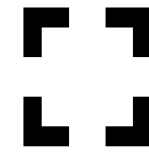

Reduced  
GLA  
Footprint



# How goods are traditionally transported across Sydney

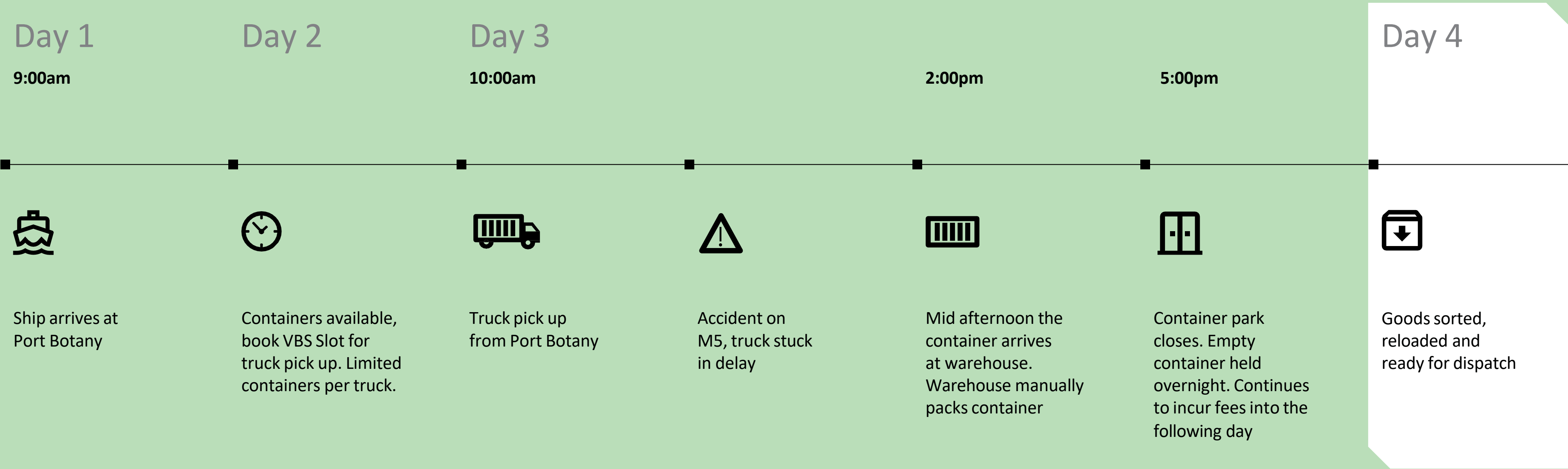



# How goods are shipped at Moorebank Intermodal

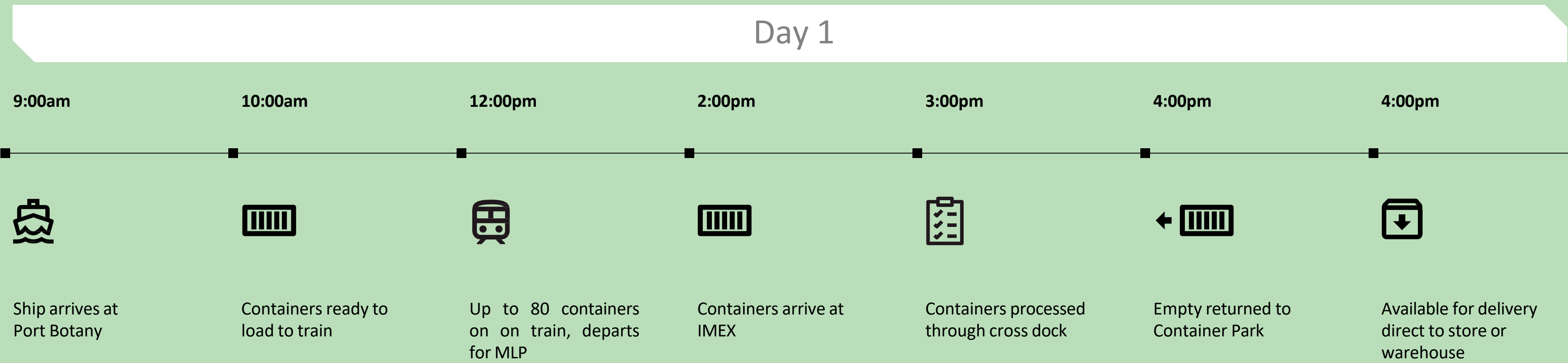



# Road V Rail Container Pricing

## 40 Foot Comparison: On Site De-hire

Road Rate		
Per container price, Return Journey by Road	High Volume TEU	Lower Volume TEU
Base rate (volume dependant)	\$397	\$510
Fuel surcharge	\$99	\$128
Tolls	\$85	\$85
VBS Timeslot Fee	\$62	\$62
TAC – Terminals Access Charge	\$195	\$195
Empty Container Notification Fee	\$229	\$229
Total	\$1067	\$1209

Rail Rate	
Full container – Ex Port Botany - IMEX	\$128
Empty Container - Ex Moorebank IMEX to Port Botany	\$128
IMEX Terminal Lift on/Lift off	\$138
IMEX Terminal to Warehouse / Return to IMEX Lift in / Lift out	\$52
TIF – Terminal Infrastructure fee	\$195
De-hire at MCS Cooks River	\$229
Total	\$870

Rail Base Rate  
\$446



Additional savings to be gained when you de-hire onsite at Moorebank Empty Park (MEP)



# Sustainability



## Towards Carbon neutral

20+ MW of rooftop solar panelscapable of meeting the electricity needs of the warehouses and precinct infrastructure.



## Innovation

World’s first fully automated intermodal terminal for containerised freight.



## Urban Heat Island Reduction

Implement strategies that will target a temperature reduction within the surface and canopy layer of the site.



## Enhanced Biodiversity

Establishment of biobank sites to manage the long-term ecological values of the site and offset the development’s biodiversity impacts.



## Electric Vehicle Infrastructure

Electric Vehicle charging points within estate carparks to encourage EV usage.



## Reduction in embodied carbon

Reductions in embodied carbon in construction materials achieved through replacement materials and value engineering.



# Shaping Australia’s sustainable future

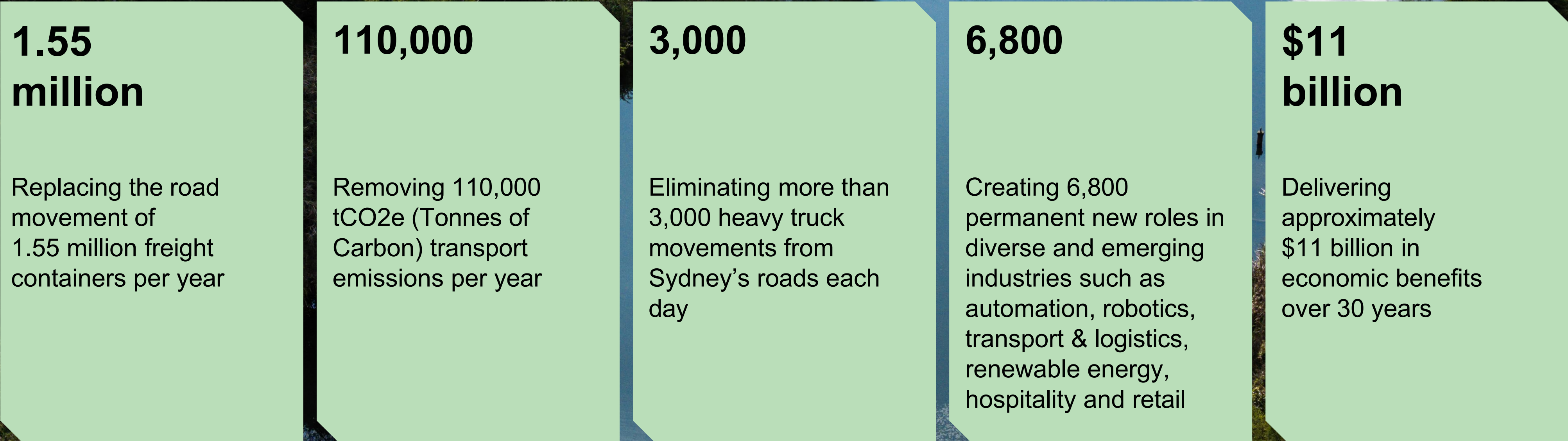



# A thriving onsite community

Proposed future amenities may include vibrant retail hubs located throughout the precinct, providing convenient access to everyday essentials, and lifestyle services for employees and the wider community.



Disclaimer: subject to change without notice



# The Future of Australian Logistics



Moorebank Intermodal Precinct brought to you by ESR, National Intermodal and Qube Logistics. Together we are delivering cutting-edge industrial, logistics and intermodal property solutions to support our customers’ growth and success — The Future of Australian Logistics.

## Partnering with



## Backed by



**Contact**  
David Brandon-Cooper  
M: 0418 265 223  
E: David.Brandon-Cooper@esr.com



**Contact**  
Danielle Eloss  
M: 0405 996 623  
E: Danielle.Eloss@esr.com