

BREAKLINE - REFER TO DRAWING 0404 FOR CONTINUATION

LEGEND:
LEVELS DATUM IS AHD.

EXISTING SITE LEVELS AND DETAILS BASED ON SURVEY INFORMATION PROVIDED BY CARNO DATED 05.08.2019

- SGGP, SINGLE GRATED GULLY PIT
- SJP, SEALED JUNCTION PIT
- KIP, KERB INLET PIT
- PROPOSED DRAINAGE LINE
- DRAINAGE LINE OUTSIDE GEORGIU SCOPE
- OVERLAND FLOW DIRECTION
- FINISHED PAVEMENT CONTOUR (MAJOR) 1.0m INTERVALS
- FINISHED PAVEMENT CONTOUR (MINOR) 0.25m INTERVALS
- EXISTING CONTOUR (MINOR) 0.1m INTERVALS
- BIO-BANKING AREA
- CONSTRUCTION BOUNDARY

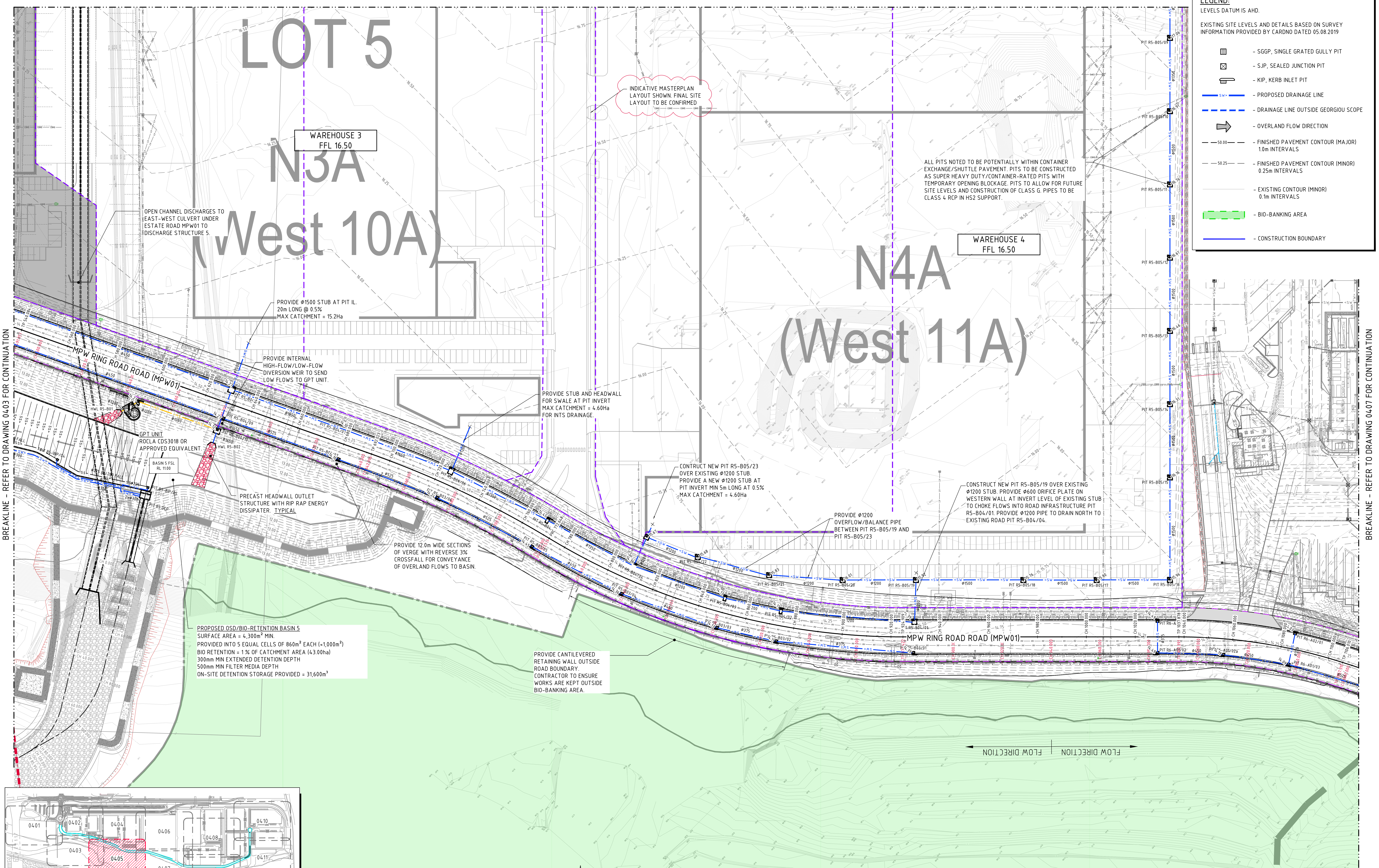

BREAKLINE - REFER TO DRAWING 0403 FOR CONTINUATION

BREAKLINE - REFER TO DRAWING 0407 FOR CONTINUATION

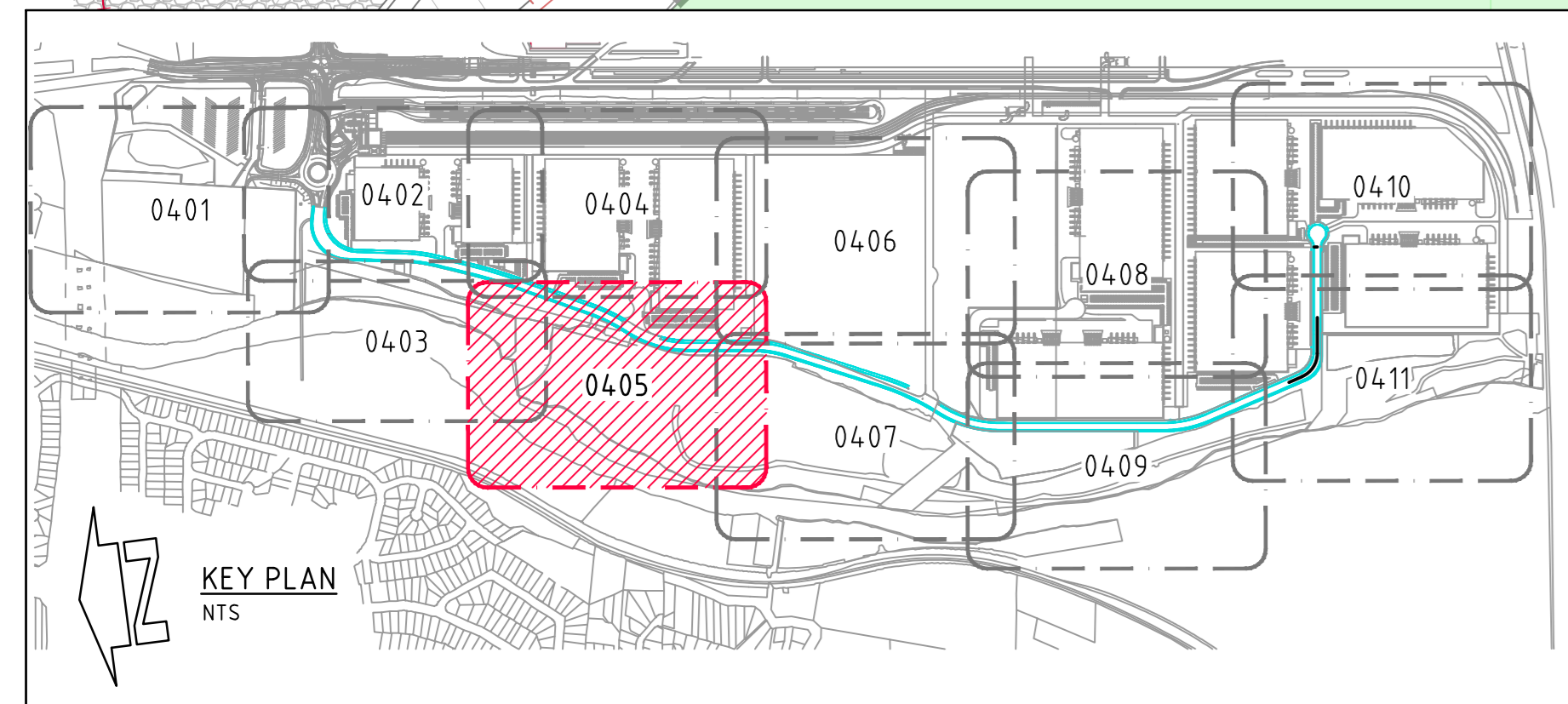

STORMWATER DRAINAGE PLAN - SHEET 5
1:500 SCALE

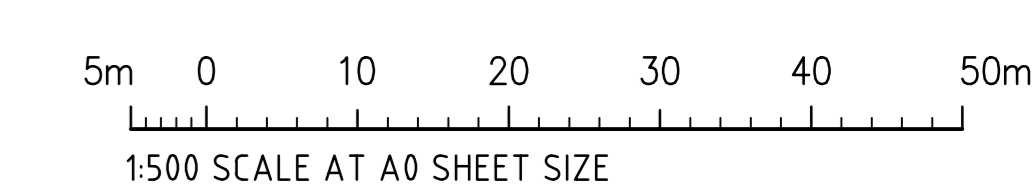

FOR CONSTRUCTION

AMENDMENTS	DATE	ISSUE	AMENDMENTS	DATE	ISSUE
REVISED SPOT LEVELS	22.12.20	7	REVISED NTS/ISRA DRAINAGE LAYOUT	29.04.24	13
REVISED AS CLOUDED	24.11.20	6	REVISED N4 SOUTHERN TRUNK DRAINAGE CHANNEL	20.11.23	12
REVISED AS CLOUDED	16.11.20	5	ISSUED FOR CONSTRUCTION	05.05.22	11
CONSTRAINTS MAPPING ADDED	04.11.20	4	REVISED CROSSOVER LOCATION	14.05.21	10
REVISED STUB PIPE SIZE	29.10.20	3	REVISED ROAD CHAINAGES	18.02.21	9
REVISED FOR RE-ALIGNED RING ROAD	10.07.20	2	REVISED ROAD CHAINAGES	22.01.21	8

DEVELOPER

ARCHITECT

PROJECT MANAGER

CONSULTING CIVIL INFRASTRUCTURE ENGINEERS & PROJECT MANAGERS

PROJECT

PRECINCT INFRASTRUCTURE WORKS WEST
MOOREBANK AVENUE, MOOREBANK

DESIGNED: [] DRAWN: [] DATE: AUG 19 CHECKED: [] SIZE: [] SCALE: [] CAD REF: []

CONSULT AUSTRALIA

Costin Roe Consulting Pty Ltd.
Consulting Engineers
Level 1, 8 Windmill Street
Wahlab Bay, Sydney NSW 2000
Tel: (02) 9251-7899 Fax: (02) 9241-3721
email: mail@costinroe.com.au

PRECISION | COMMUNICATION | ACCOUNTABILITY

DRAWING TITLE

STORMWATER DRAINAGE PLAN SHEET 5

DRAWING NO: LPWPIW-COS-CV-DWG-0405

ISSUE 13