

SIGNAGE:

	TYPE 1 STREET SIGNAGE
	TYPE 2 TENANT IDENTIFICATION SIGNAGE
	TYPE 3 DIRECTION SIGNAGE
	TYPE 4 CORPORATE SIGNAGE

LEGEND:

	UDLP AREA 2
	WAREHOUSE
	OFFICE
	SHARED PATHWAY
	LANDSCAPE
	OSD

- NOTES:**
- UNLESS REFERENCED TO A SITE PLAN, AREAS ARE INDICATIVE ONLY AND SUBJECT TO CHANGE AND DETAIL DESIGN. REFER TO AREA SPECIFIC SITE PLANS FOR DETAILS WHERE AVAILABLE.
 - LANDSCAPE CALCULATIONS ARE SUBJECT TO LANDSCAPE ARCHITECTS INPUT.
 - LANDSCAPE CALCULATIONS SUBJECT TO WORKS AND MEASUREMENTS ON SITE.

- NOTES:**
- ALL LEVELS ARE INDICATIVE & SHOULD BE READ IN CONJUNCTION WITH CIVIL ENG. DWGS FOR FINAL LEVELS OF ALL EARTH WORKS.
 - ALL SERVICES RELOCATION TO BE CONFIRMED BY ENG.
 - ALL DESIGNS ARE INDICATIVE AND SUBJECT TO DETAILED DESIGN.
 - LANDSCAPE IS SHOWN INDICATIVELY AND IS SUBJECT TO LANDSCAPE ARCHITECTS INPUT.

Notes

- This drawing and design is subject to Reid Campbell (NSW) Pty Ltd copyright and may not be reproduced without prior written consent.
- Contractor to verify all dimensions on site before commencing work.
- Report all discrepancies to project manager prior to construction.
- Figured dimensions to be taken in preference to scaled drawings.
- All work is to conform to relevant Australian Standards and other Codes as applicable, together with other Authorities' requirements and regulations.

NSW Registered Architect Mark David Roach, 10332
NSW Registered Architect James Webb, 10187

Issue	Description	Date	DR	CH
A	Issue for Information	22.04.2020	AM	MF
B	For Submission	09.06.2020	AM	MF
C	For Submission	19.06.2020	AM	MF

REID CAMPBELL
Architecture, Interiors, Project Management
ACN 002 033 891 ABN 28 517 959 875
Level 15, 124 Walker Street
North Sydney NSW 2060 Australia
Tel: 61 02 9954 5011 Email: sydney@reidcampbell.com
Fax: 61 02 9954 4946 Web: www.reidcampbell.com

**MOOREBANK
PRECINCT
EAST - STAGE 2**

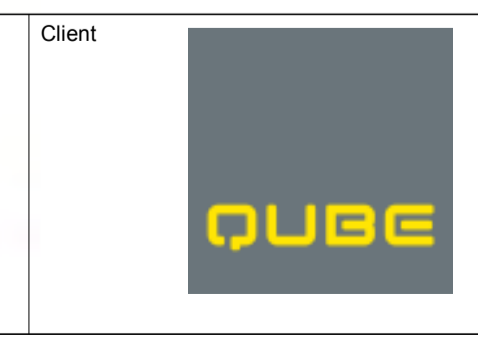

Project	MOOREBANK PRECINCT EAST	
MOOREBANK AVENUE, MOOREBANK, NSW		
Drawn	Checked	Print Date
AM	MF	19/06/2020 9:40:12 AM

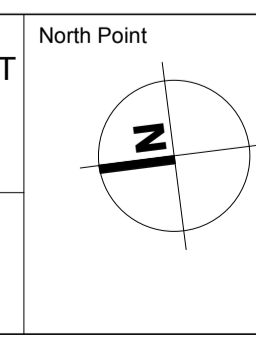

Drawing Title	MPE UDLP - AREA 5
Drawing Number	SSS2-RCG-AR- SKC-177
Issue	C

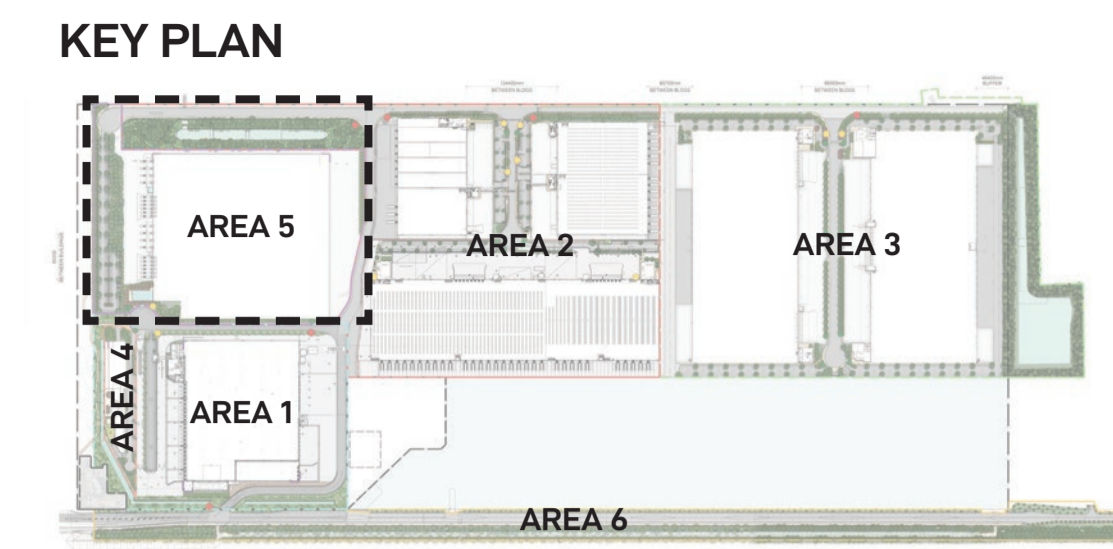
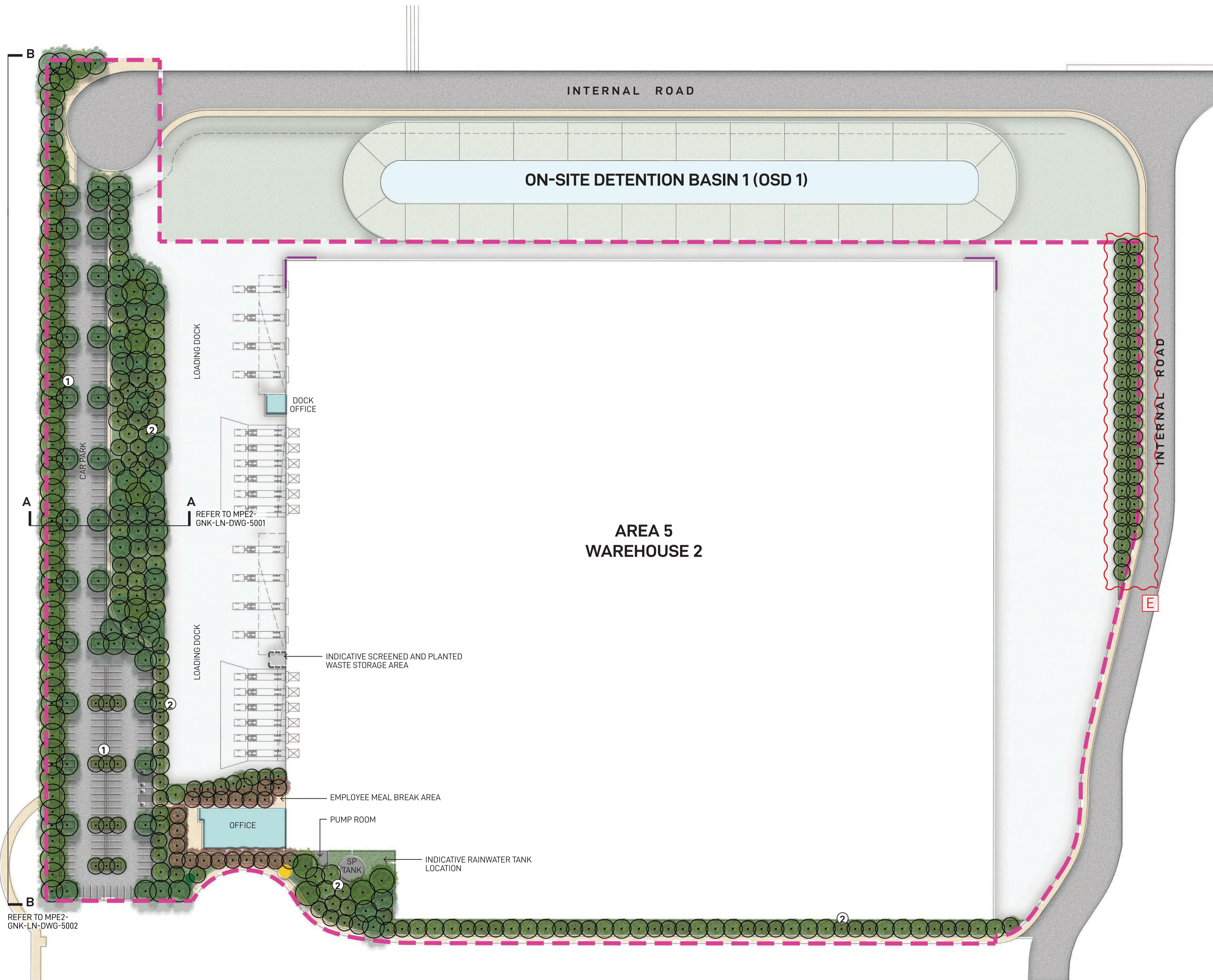

- LEGEND**
- Area 5 Boundary
 - Hard Landscaping
 - Proposed Garden Bed
 - Proposed Canopy Trees
 - Type 1 Street Signage
 - Type 2 Tenant Identification Signage
 - Type 3 Direction Signage
 - Type 4 Corporate Signage
- 1 Proposed canopy tree planting in 2.5M carpark bays spaced at every 6-8 car spaces providing amenity and visual screening of proposed warehousing in accordance with condition b140(e)(iii) & b140(e)(vi)
- 2 Proposed mix of native canopy trees and shrubs providing visual mitigation of proposed warehouses
- NOTE**
Elements shown in plans are indicative and are subject to final design

INDICATIVE TREES

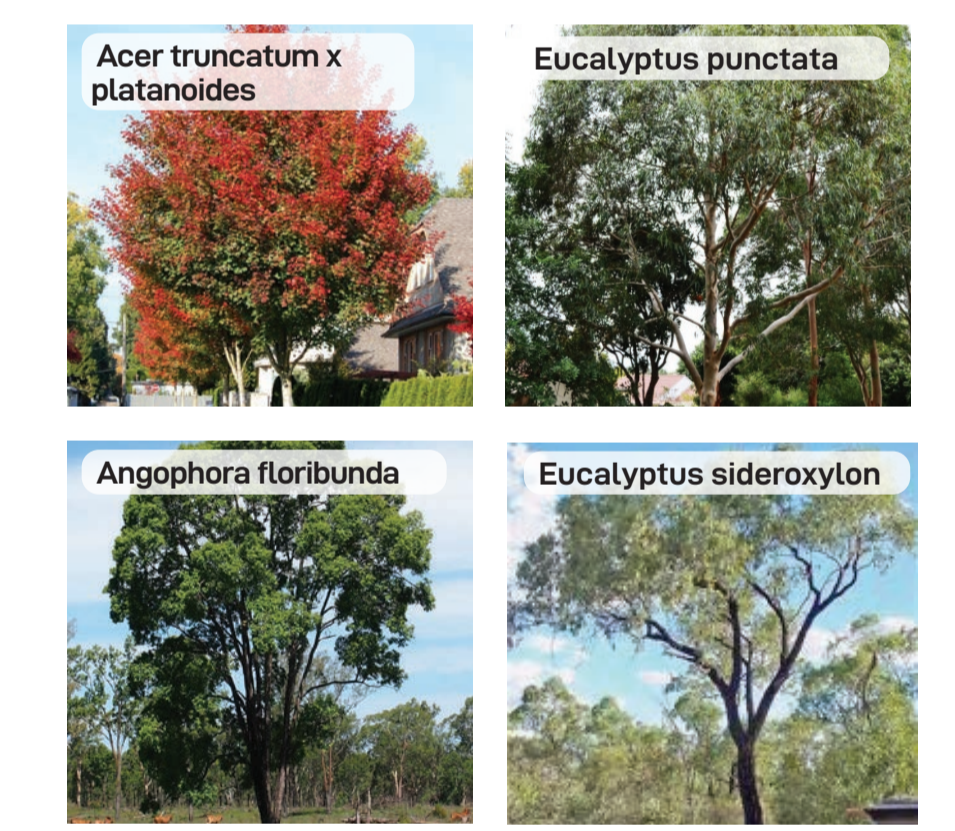

INDICATIVE SHRUB & GRASSES



Landscape Architect
GROUND INK
Suite 201, 75 Archer St, Chatswood NSW 2067 Ph. (02) 9411 3279
www.groundink.com.au ABN 55 163 025 456 ACN 163 025 456
© Ground Ink Pty Ltd This design and drawing is protected by copyright.

Client
LOGOS
29/88 Phillip Street, Sydney, NSW 2000
Ph. (02) 83290730
www.logosproperty.com.au

Architect
watson young
15 Blue Street, North Sydney NSW 2060
Ph. (02) 83290730
www.watsonyoung.com.au

Project Manager
ASPECT
Suite 117 / 25 Solent Circuit
Baulkham Hills NSW 2153
Ph. 0409 515 535
http://aspectenvironmental.com.au/

Note
Verify all dimensions on site before commencing work. Report all discrepancies to Landscape Architect prior to construction. Figured dimensions to be taken in preference to scaled drawings.
All work is to conform to relevant Australian standards and other codes as applicable.
Location of underground services to be proven on site and protected if necessary prior to construction. Dial before you dig.
Plant species and quantities shown are indicative only and are subject to change based on future project requirements.

Issue	Date	Description	Drawn	Checked
A	04.04.20	Issue for Coordination	KF	RL
B	28.10.20	Issue for Coordination	KF	RL
C	28.10.20	Issue for Coordination	KF	RL
D	16.12.20	Issue for Coordination	KF	RL
E	21.07.22	Issue for Coordination	WL	RL

Drawing Title
**AREA 5
LANDSCAPE MASTERPLAN**

FOR COORDINATION

Date	Job Number	Drawn	Checked	Drawing Number
21.07.22	20200421	WL	RL	MPE2-GNK-LN-DWG-5000

Project
Moorebank Precinct East
Moorebank Logistics Park, Moorebank NSW

Scale 1:750 @ A1

0 5 10 15 20m

North
Rev
E

KEY PLAN

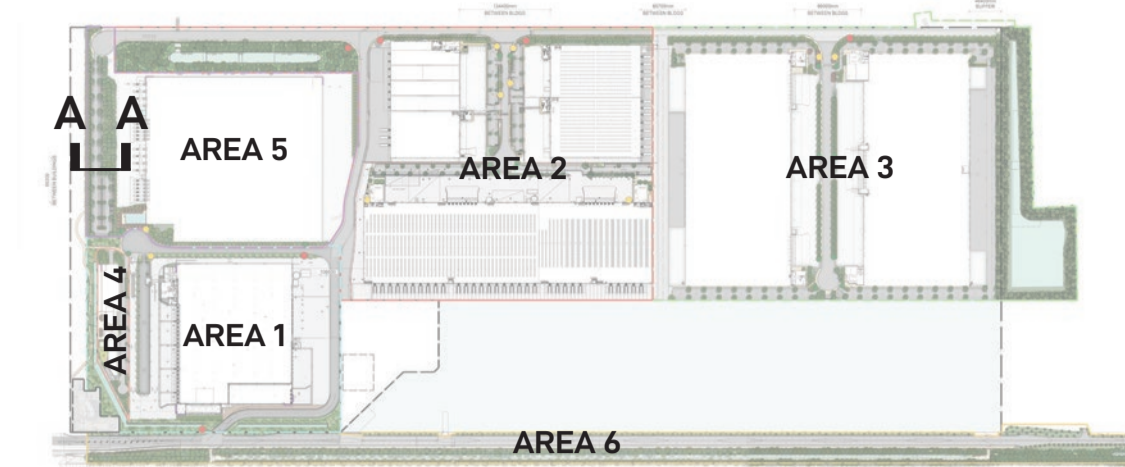

CARPARK SECTION A-A



Landscape Architect
GROUND INK
 Suite 201, 75 Archer St, Chatswood NSW 2067 Ph. (02) 9411 3279
 www.groundink.com.au ABN 55 163 025 456 ACN 163 025 456
 © Ground Ink Pty Ltd This design and drawing is protected by copyright.

Client
LOGOS
 29/88 Phillip Street, Sydney, NSW 2000
 Ph. (02) 81973900
 www.logosproperty.com.au

Architect
watson young
 15 Blue Street, North Sydney NSW 2060
 Ph. (02) 83290730
 www.watsonyoung.com.au

Project Manager
ASPECT
 Suite 117 / 25 Solent Circuit
 Baulkham Hills NSW 2153
 Ph. 0409 515 535
 http://aspectenvironmental.com.au/

Note
 Verify all dimensions on site before commencing work. Report all discrepancies to Landscape Architect prior to construction. Figured dimensions to be taken in preference to scaled drawings.
 All work is to conform to relevant Australian standards and other codes as applicable.
 Location of underground services to be proven on site and protected if necessary prior to construction. Dial before you dig.
 Plant species and quantities shown are indicative only and are subject to change based on future project requirements.

Issue	Date	Description	Drawn	Checked
A	04.04.20	Issue for Coordination	KF	RL
B	28.10.20	Issue for Coordination	KF	RL
C	28.10.20	Issue for Coordination	KF	RL
D	16.12.20	Issue for Coordination	KF	RL
E	21.07.22	Issue for Coordination	WL	RL

Drawing Title
**AREA 5
 LANDSCAPE SECTION**

FOR COORDINATION

Date	Job Number	Drawn	Checked	Drawing Number
21.07.22	20200421	WL	RL	MPE2-GNK-LN-DWG-5001

Project
Moorebank Precinct East
 Moorebank Logistics Park, Moorebank NSW

Scale 1:75 @ A1

0 0.5 1 1.5 2m

North
 Rev
 E

KEY PLAN

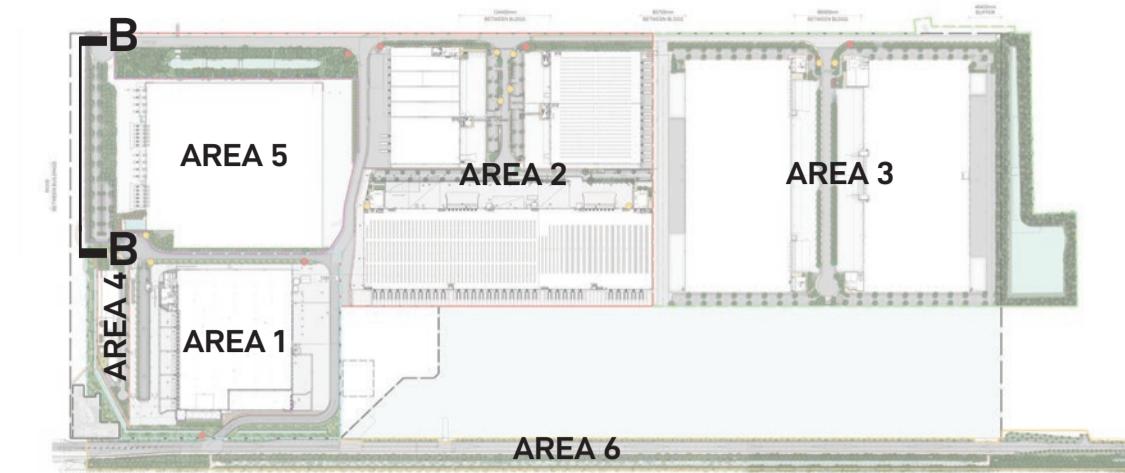

WAREHOUSE 2 NORTH ELEVATION B-B

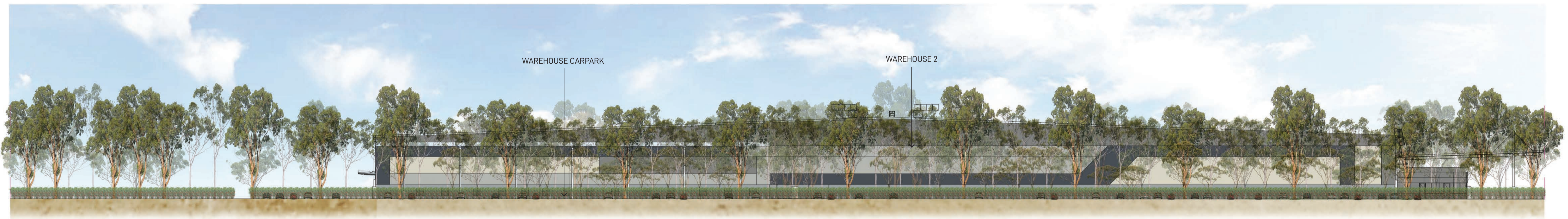

FOR COORDINATION

Landscape Architect
GROUND INK
 Suite 201, 75 Archer St, Chatswood NSW 2067 Ph. (02) 9411 3279
 www.groundink.com.au ABN 55 163 025 456 ACN 163 025 456
 © Ground Ink Pty Ltd This design and drawing is protected by copyright.

Client
LOGOS
 29/88 Phillip Street, Sydney, NSW 2000
 Ph. (02) 81973900
 www.logosproperty.com.au

Architect
watson young
 15 Blue Street, North Sydney NSW 2060
 Ph. (02) 83290730
 www.watsonyoung.com.au

Project Manager
ASPECT
 Suite 117 / 25 Solent Circuit
 Baulkham Hills NSW 2153
 Ph. 0409 515 535
 http://aspectenvironmental.com.au/

Note
 Verify all dimensions on site before commencing work. Report all discrepancies to Landscape Architect prior to construction. Figured dimensions to be taken in preference to scaled drawings.
 All work is to conform to relevant Australian standards and other codes as applicable.
 Location of underground services to be proven on site and protected if necessary prior to construction. Dial before you dig.
 Plant species and quantities shown are indicative only and are subject to change based on future project requirements.

Issue	Date	Description	Drawn	Checked
A	04.04.20	Issue for Coordination	KF	RL
B	28.10.20	Issue for Coordination	KF	RL
C	28.10.20	Issue for Coordination	KF	RL
D	16.12.20	Issue for Coordination	KF	RL
E	21.07.22	Issue for Coordination	WL	RL

Drawing Title
**AREA 5
 LANDSCAPE ELEVATION**

Date	Job Number	Drawn	Checked	Drawing Number
21.07.22	20200421	WL	RL	MPE2-GNK-LN-DWG-5002
Project Moorebank Precinct East Moorebank Logistics Park, Moorebank NSW				
Scale 1:200 @ A1				
0 1 2 3 4 5 6 7 8m				
Rev				North
E				North

DECEMBER 22ND 3PM

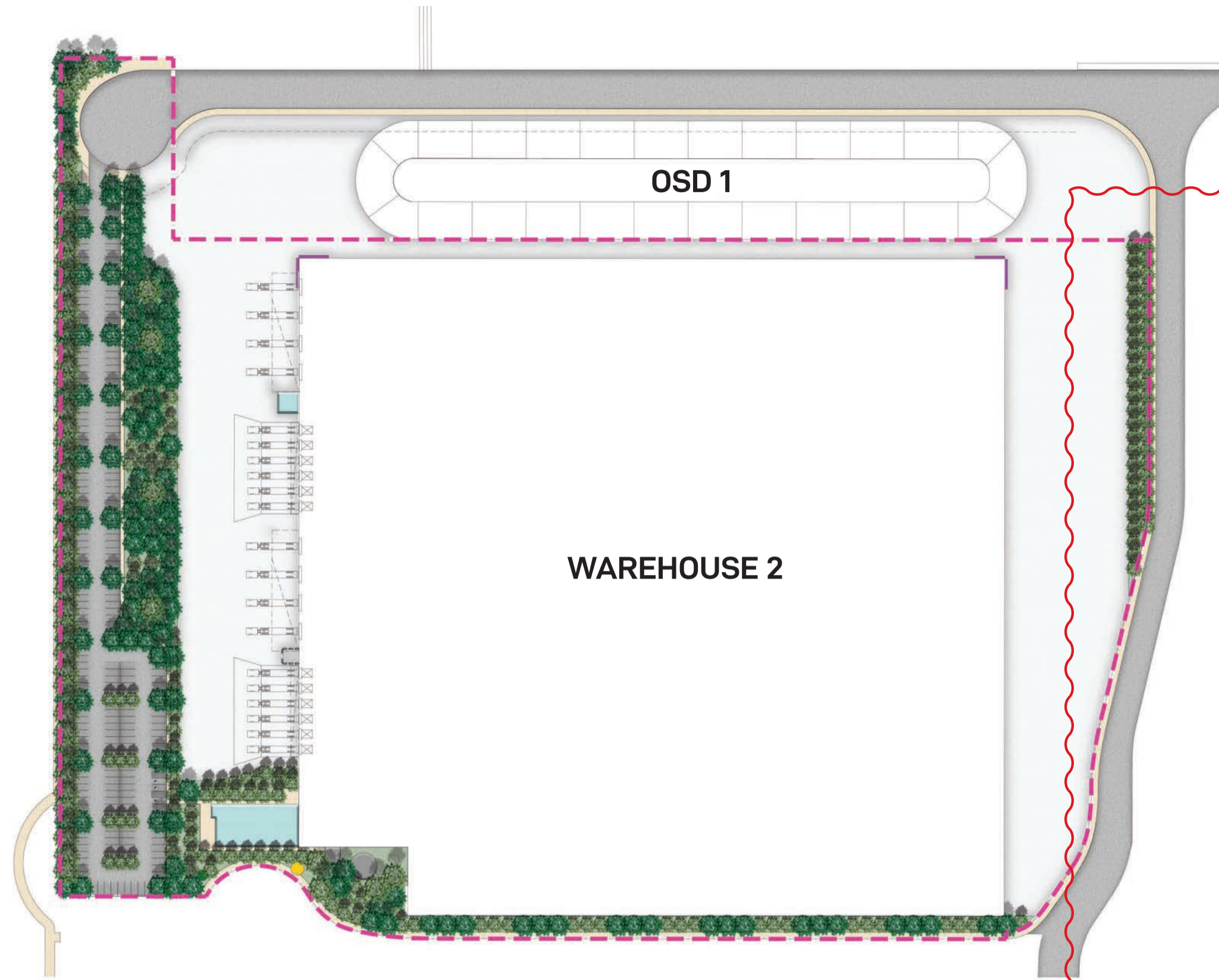

ANTICIPATED TREE GROWTH 5 YEARS AFTER INSTALLATION

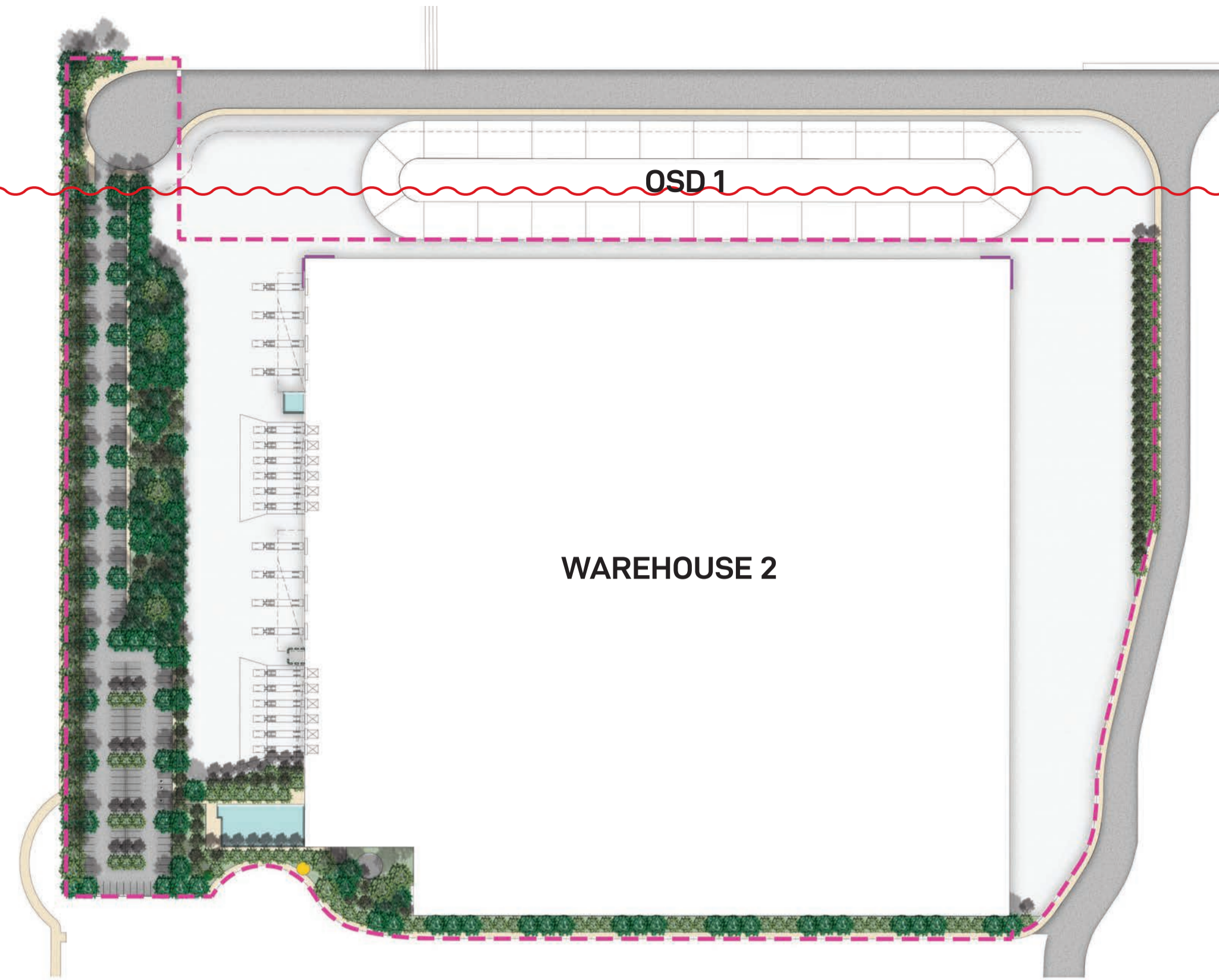

ANTICIPATED TREE GROWTH 15 YEARS AFTER INSTALLATION

JULY 22ND 3PM

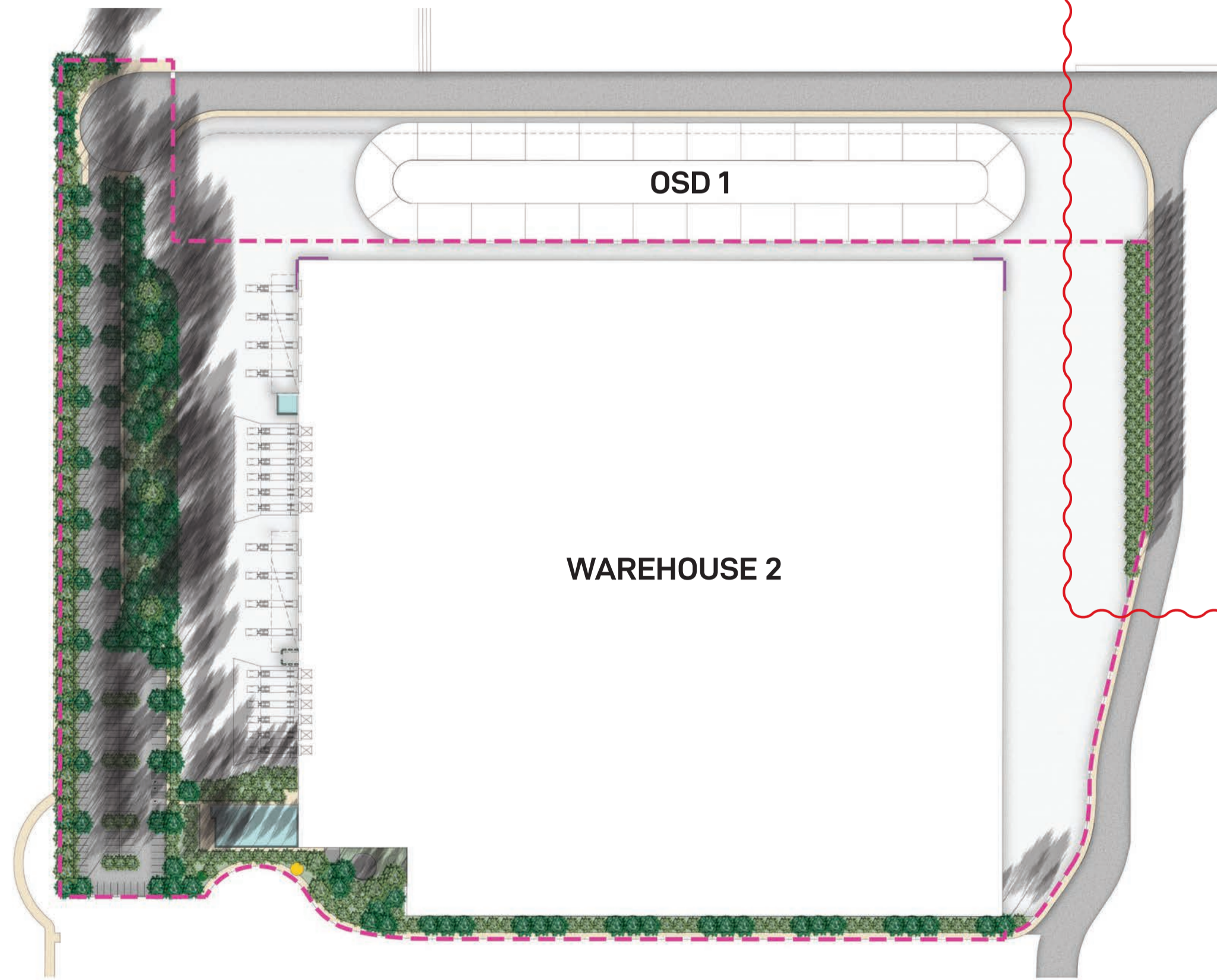

ANTICIPATED TREE GROWTH 5 YEARS AFTER INSTALLATION

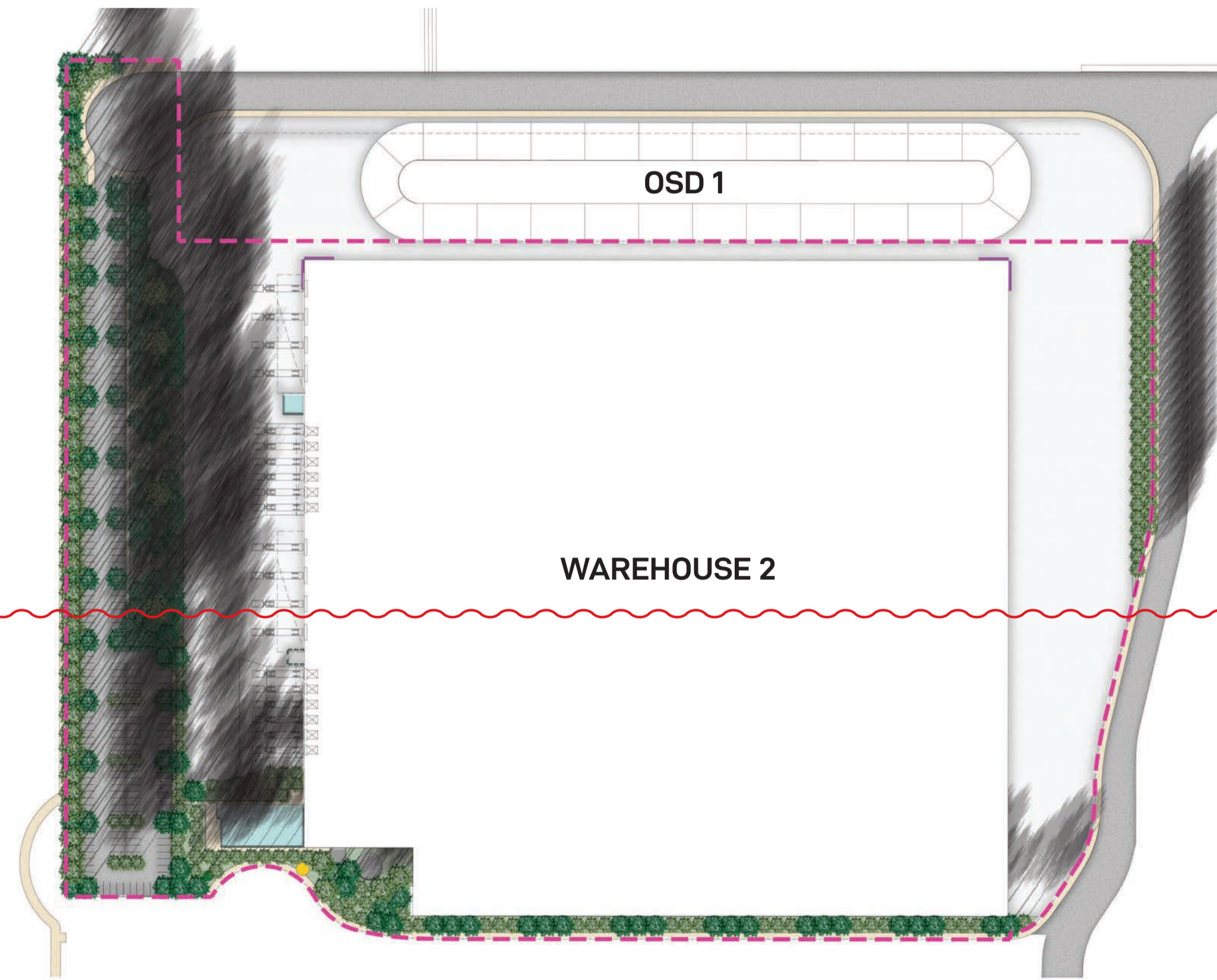

ANTICIPATED TREE GROWTH 15 YEARS AFTER INSTALLATION

NOTE
 The final height of the proposed trees may differ from those indicated and will be dependent on environmental factors, installation size, and the implementation of an appropriate maintenance regime which is subject to future specifications. Refer to Architect's details for building shade diagram

E

FOR COORDINATION

Landscape Architect GROUND INK Suite 201, 75 Archer St, Chatswood NSW 2067 Ph. (02) 9411 3279 www.groundink.com.au ABN 55 163 025 456 ACN 163 025 456 © Ground Ink Pty Ltd This design and drawing is protected by copyright.	Client LOGOS 29/88 Phillip Street, Sydney, NSW 2000 Ph. (02) 81973900 www.logosproperty.com.au	Architect watson young 15 Blue Street, North Sydney NSW 2060 Ph. (02) 83290730 www.watsonyoung.com.au	Project Manager ASPECT Suite 117 / 25 Solent Circuit Baulkham Hills NSW 2153 Ph. 0409 515 535 http://aspectenvironmental.com.au/	Note Verify all dimensions on site before commencing work. Report all discrepancies to Landscape Architect prior to construction. Figured dimensions to be taken in preference to scaled drawings. All work is to conform to relevant Australian standards and other codes as applicable. Location of underground services to be proven on site and protected if necessary prior to construction. Dial before you dig. Plant species and quantities shown are indicative only and are subject to change based on future project requirements.	Issue A 04.04.20 Issue for Coordination B 28.10.20 Issue for Coordination C 28.10.20 Issue for Coordination D 16.12.20 Issue for Coordination E 21.07.22 Issue for Coordination	Date 04.04.20 28.10.20 28.10.20 16.12.20 21.07.22	Description Issue for Coordination Issue for Coordination Issue for Coordination Issue for Coordination	Drawn KF KF KF WL	Checked RL RL RL RL	Drawing Title AREA 5 LANDSCAPE SHADOW DIAGRAMS	Date 21.07.22	Job Number 20200421	Drawn WL	Checked RL	Drawing Number MPE2-GNK-LN-DWG-5003	Project Moorebank Logistics Park East Moorebank Logistics Park, Moorebank NSW	North 	Scale NOT TO SCALE	Rev E