



Design & Consultancy
for natural and
built assets

Moorebank Precinct East - Stage 2 Proposal

Survey Plan



SIMTA

SYDNEY INTERMODAL TERMINAL ALLIANCE

Part 4, Division 4.1, State Significant
Development

December 2016

This page has been left blank intentionally

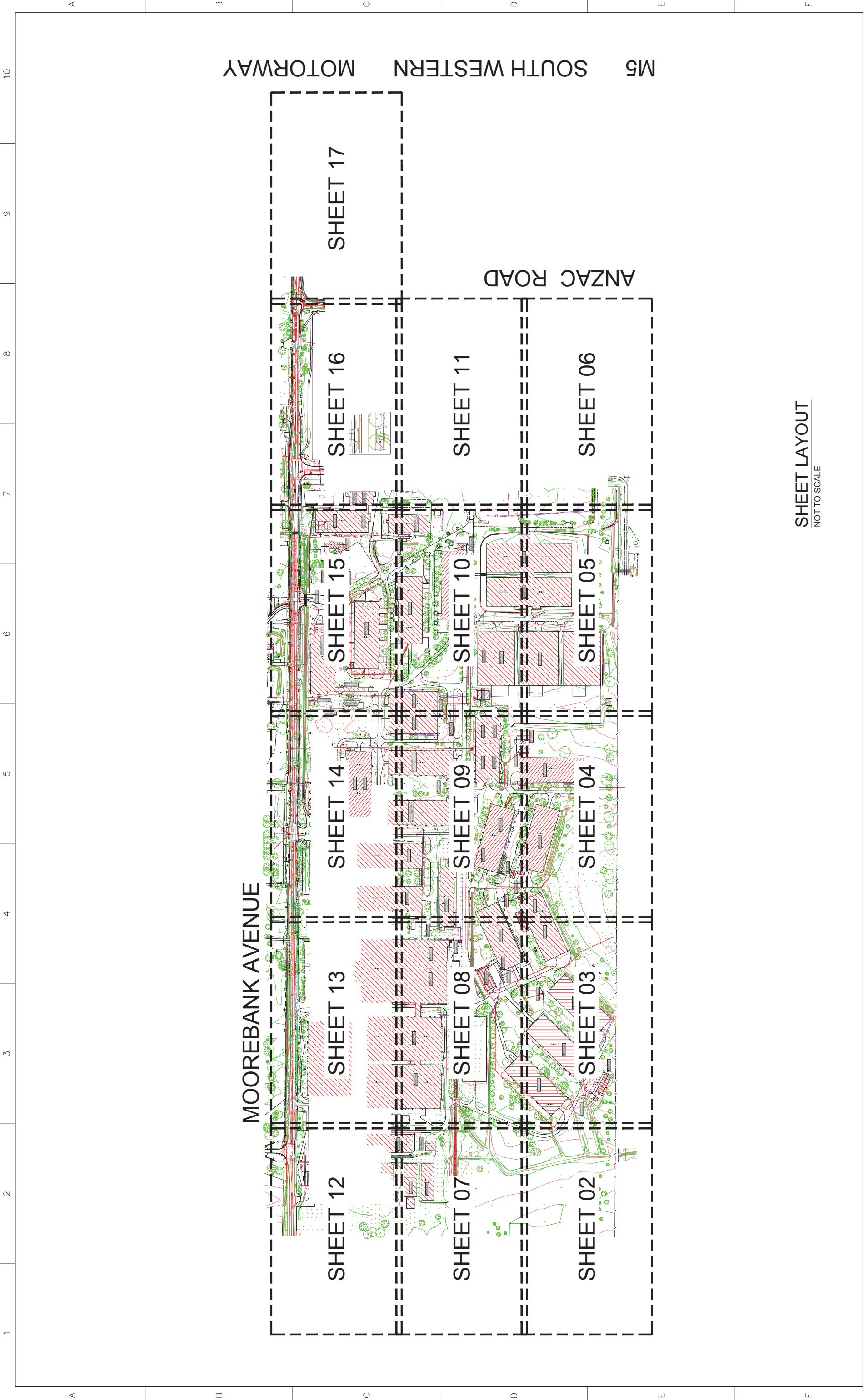

SHEET LAYOUT
NOT TO SCALE

IMPORTANT NOTE: This drawing is for TACTICAL PROJECT MANAGEMENT only. It is not to be used for design or construction purposes. It is a summary of the existing conditions and should not be used for any new construction. The site boundaries shown hereon were not marked by the author at the time of survey and have been determined by plan dimensions only and not by field measurement.



A services search of the area surveyed above has not been undertaken. Visible services shown hereon have been located where possible by field survey. Prior to any demolition, excavation or construction on the site, the location of all services and any other possible location of further underground services and detailed locations of all services. This note is an integral part of this plan.

REVISION	DATE	DESCRIPTION	12D REF	PWC APPROVED
00	23.09.2016	ORIGINAL ISSUE (EXTRACT FROM DRAWING 115804500_17)		

SCALE:	HORZ. NTS MAJOR 1:0	VERT. MINOR 0.5
CONTOUR INTERVAL:	HORIZONTAL ORIGIN	
COORD. SYSTEM	MARK ADOPTED: SSM 17778	
MGA	COORDINATES: E 308 107 627 N 6 241 567 758	
DATUM:	VERTICAL DATUM	
AHD	BM ADOPTED: PM 31039 RL: 15.212	

Cardno
Shaping the Future
23-25 Frederick Street
PO Box 175
Rockdale NSW 2216
t: (02) 9597 9700
e: surveys@cardno.com.au w: www.harofrestler.com.au

PROJECT: SIMTA - MOOREBANK
PLAN SHOWING DETAIL, LEVELS AND CONTOURS
EXTRACT FROM DRAWING 115804500 REV 17 FOR MPE STAGE 2

SHEET 01 OF 17	DRAWING NUMBER	115804522
REV	REV	00



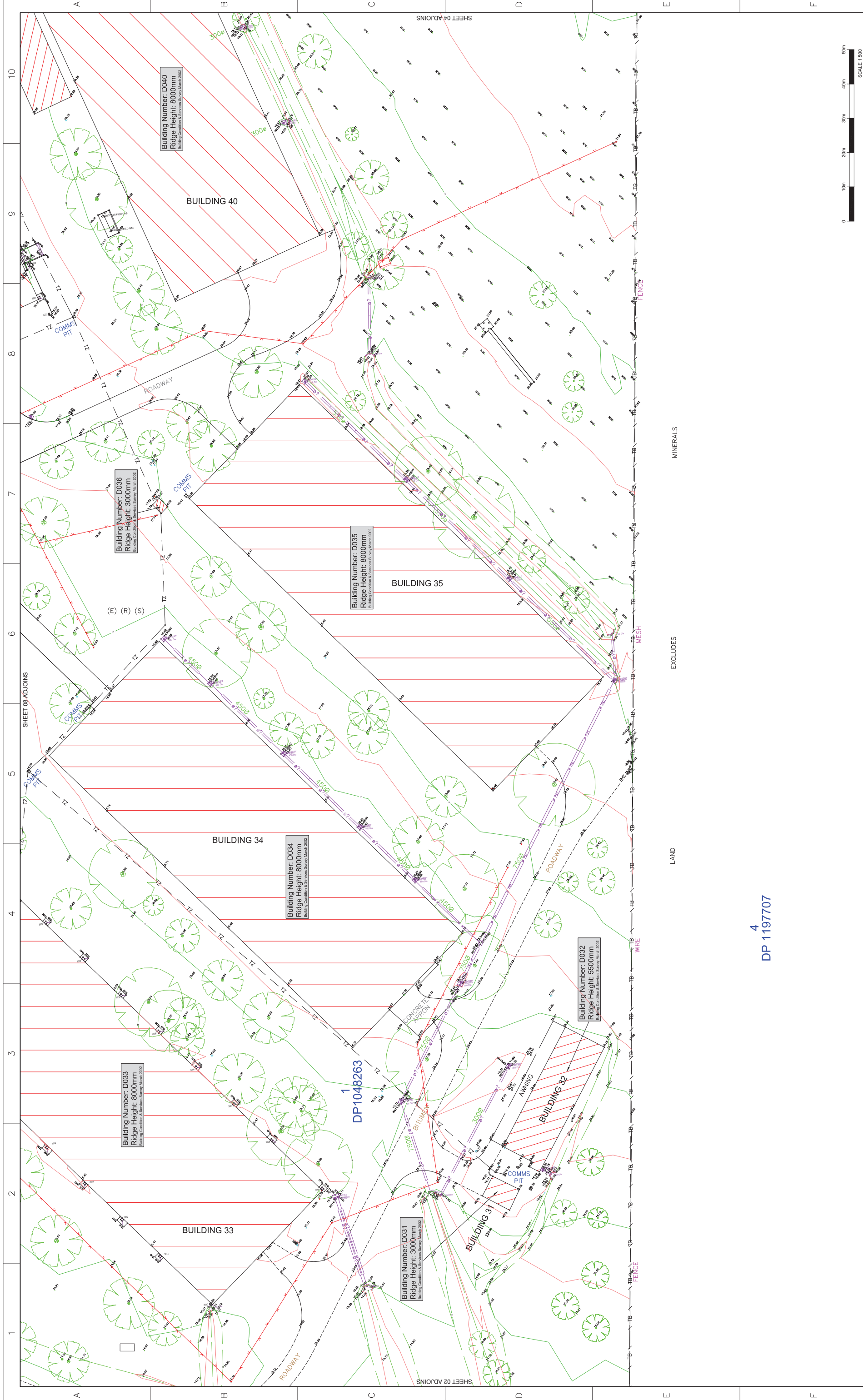

4
DP 1197707

IMPORTANT NOTE: This drawing is for TACTICAL PROJECT MANAGEMENT only. It is not to be used for designing new constructions on the land and should not be used for any excavation or construction on the site. The life boundaries shown hereon were not marked by the author at the time of survey and have been determined by plan dimensions only and not by field measurement.

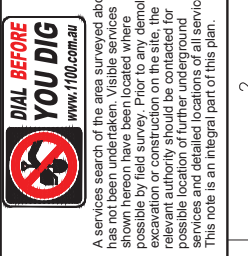

REVISION	DATE	DESCRIPTION	12D REF	APPROVED
00	23.09.2016	ORIGINAL ISSUE (EXTRACT FROM DRAWING 115804500_17)		PWC

SCALE: HORZ. 1:500	VERT. MINOR 0.5
CONTOUR INTERVAL: MAJOR 1.0	HORIZONTAL ORIGIN
COORD. SYSTEM MGA	MARK ADOPTED: SSM 17778
DATUM: AHD	COORDINATES: E 308 107 827
	N 6 241 567 758
	VERTICAL DATUM
	BM ADOPTED: PM 31039
	RL: 15.212

Cardno
Shaping the Future

23-25 Frederick Street
PO Box 175
Rockdale NSW 2216
t: (02) 9597 9700
e: surveys@cardno.com.au w: www.harofrester.com.au

BW/GOJHL/HAH
DRAWN IT/AH
CHECKED A.H.
PASSED A.H.

PROJECT: SIMTA - MOOREBANK
PLAN SHOWING DETAIL, LEVELS AND CONTOURS
EXTRACT FROM DRAWING 115804500 REV 17 FOR MPE STAGE 2

CLIENT: TACTICAL PROJECT MANAGEMENT

SHEET 03 OF 17
DRAWING NUMBER 115804522
REV 00

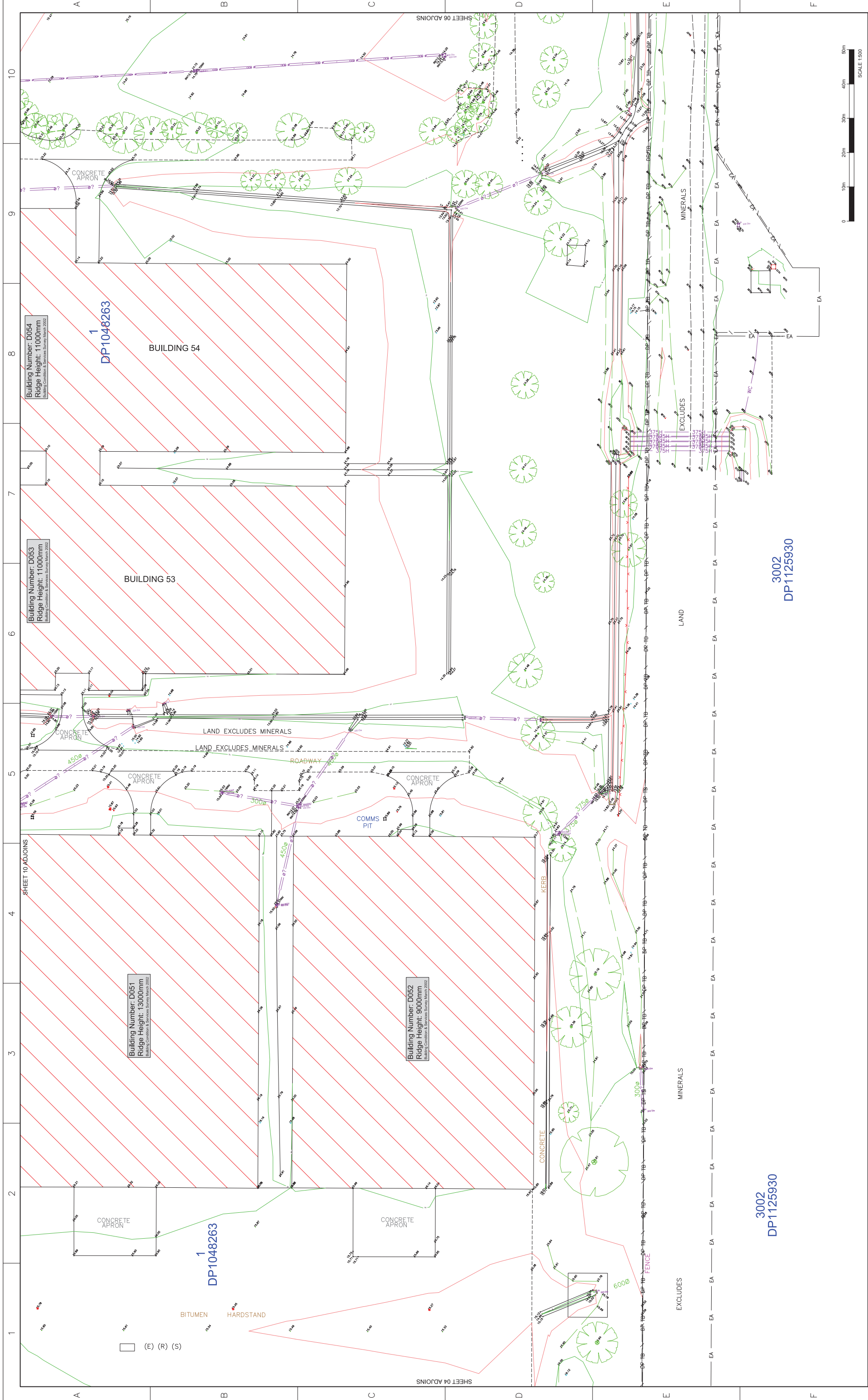

SHEET	05	OF	17
DRAWING NUMBER	115804522		
REV	00		

PROJECT: SIMTA - MOOREBANK
 PLAN SHOWING DETAIL, LEVELS AND CONTOURS
 EXTRACT FROM DRAWING 115804500 REV 17 FOR MPE STAGE 2
 CLIENT: TACTICAL PROJECT MANAGEMENT

Cardno
 Shipping the Future
 23-25 Frederick Street
 PO Box 175
 Rockdale NSW 2216
 t: (02) 9597 9700
 e: surveys@cardno.com.au w: www.haroforester.com.au

SURVEYED	DRAWN	CHECKED	PASSED
BW/GOU/HJ/H/AH	IT/AH	A.H.	A.H.

SCALE: HORZ. 1:500	VERT.
CONTOUR INTERVAL: MAJOR 1.0	MINOR 0.5
COORD. SYSTEM	MGA
DATUM:	AHD

REVISION	DATE	DESCRIPTION
00	23.09.2016	ORIGINAL ISSUE (EXTRACT FROM DRAWING 115804500_17)

DIAL BEFORE YOU DIG
 www.1100.com.au
 A services search of the area surveyed above has not been undertaken. Visible services shown hereon have been located where possible by field survey. Prior to any demolition, excavation or construction on the site, the location of any underground services or possible location of further underground services and detailed locations of all services. This note is an integral part of this plan.

IMPORTANT NOTE: This drawing is for TACTICAL PROJECT MANAGEMENT only. It is not to be used for any other purpose. The author is not responsible for any errors or omissions in this drawing. The author is not responsible for any damage or injury caused by the use of this drawing.

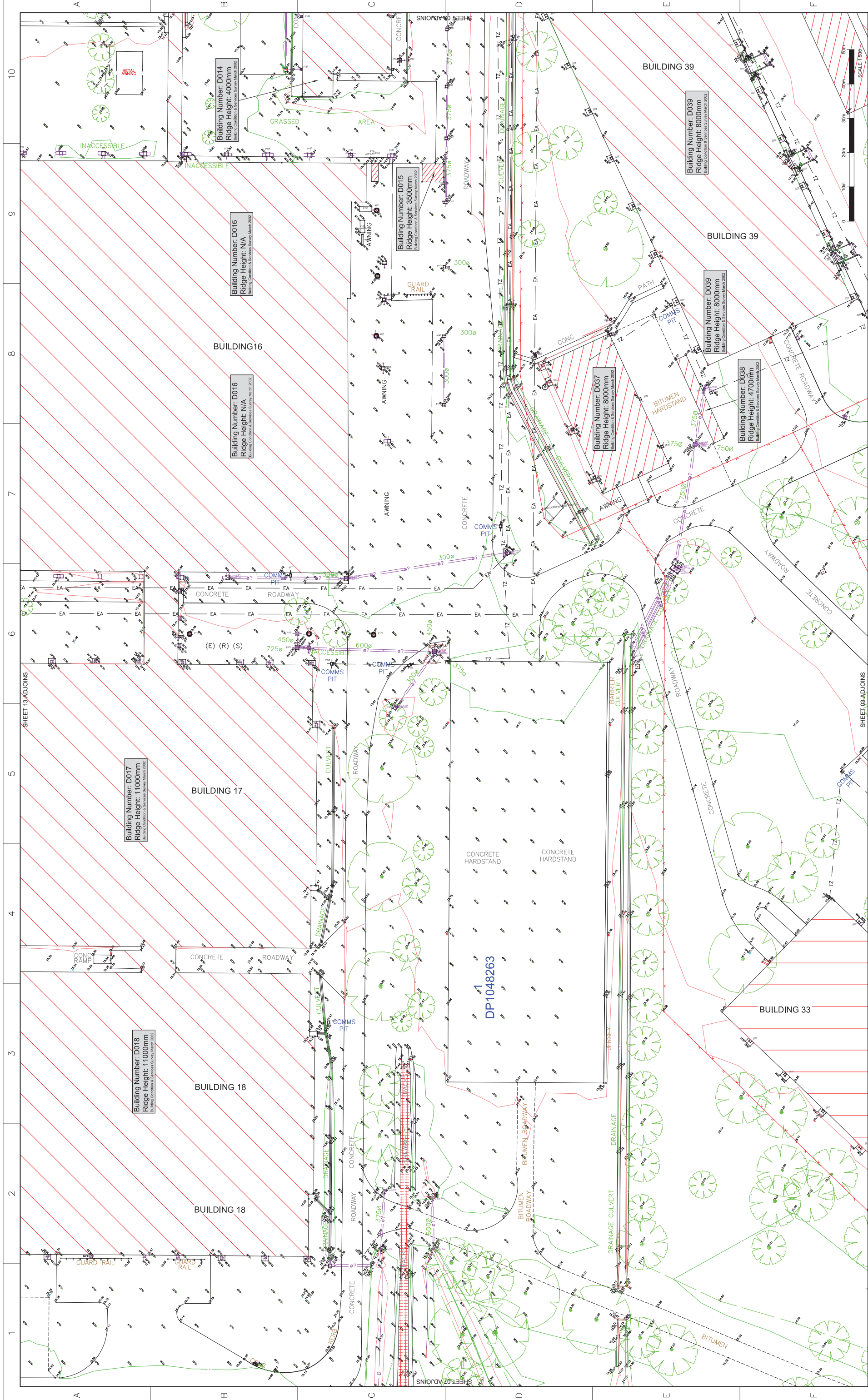

IMPORTANT NOTE: (for TACTICAL PROJECT MANAGEMENT) This drawing is a representation of the site and should not be used for any design or construction purposes. The information shown hereon was derived from a survey conducted by the author and is not a guarantee of accuracy. The author is not responsible for any errors or omissions in this drawing. This note is an integral part of this plan.

DIAL BEFORE YOU DIG
www.1100.com.au

A services search of the area surveyed above has not been undertaken. Visible services shown hereon have been located where possible by field survey. Prior to any excavation or construction on the site, the location of any services should be confirmed by a qualified person or by other means. The location of any services and detailed locations of all services. This note is an integral part of this plan.

REVISION	DATE	DESCRIPTION	12D REF	PWC APPROVED	REVISED BY
00	23.09.2016	ORIGINAL ISSUE (EXTRACT FROM DRAWING 115804500-17)			

DATE	DRAWN	CHECKED	PASSED	CLIENT	PROJECT
23.09.2016	BW/GOUJH/IAH	IT/IAH	A.H.	TACTICAL PROJECT MANAGEMENT	SIMTA - MOOREBANK

COORD. SYSTEM	MARK ADOPTED	HORIZONTAL ORIGIN	CONTOUR INTERVAL	SCALE	SHEET ADJOINS
MGA	SSM 17778	EA 308 107 827 E 6 241 567 758	MAJOR 1.0 MINOR 0.5	1:500	DP1048263

DRAWING NUMBER	SHEET	OF	REV	DRAWING NUMBER	SHEET
115804522	12	17	00	115804522	10

PLAN SHOWING DETAIL, LEVELS AND CONTOURS
EXTRACT FROM DRAWING 115804500 REV 17 FOR MPE STAGE 2

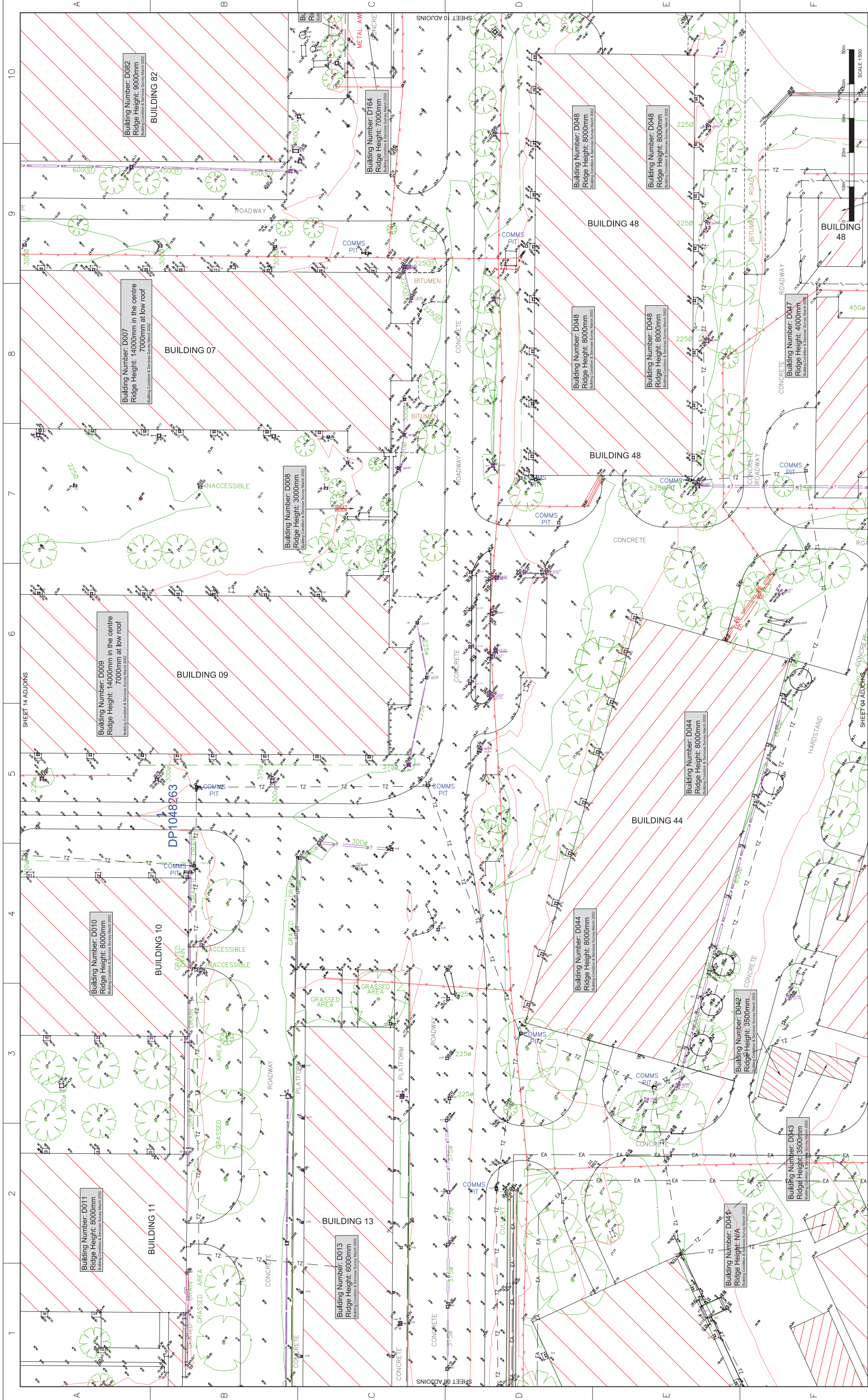

IMPORTANT NOTE: (for TACTICAL PROJECT MANAGEMENT) This drawing is a summary of existing records for the purpose of designing new constructions on the land and should not be used for any excavation or construction on the site. The life boundaries shown hereon were surveyed and have been determined by plan dimensions only and not by field measurement.

DIAL BEFORE YOU DIG
www.1100.com.au

A services search of the area surveyed above has not been undertaken. Visible services shown hereon have been located where possible by field survey. Prior to any demolition, excavation or construction on the site, the location of any services and/or possible services and detailed locations of all services. This note is an integral part of this plan.

PROJECT: SIMTA - MOOREBANK

PLAN SHOWING DETAIL, LEVELS AND CONTOURS

EXTRACT FROM DRAWING 115804500 REV 17 FOR MPE STAGE 2

CARDNO
Shaping the Future
23-25 Frederick Street
PO Box 175
Rockdale NSW 2216
t: (02) 9597 9700
e: surveys@cardno.com.au www.hardofrester.com.au

CLIENT: TACTICAL PROJECT MANAGEMENT

DATE: 23.09.2016

REVISION: 00

DESCRIPTION: ORIGINAL ISSUE (EXTRACT FROM DRAWING 115804500_17)

DATE: 23.09.2016

REVISION: 00

APPROVED: PWC

12D REF:

DATUM: AHD

BM ADAPTED: PM 31039

RL: 15.212

COORD. SYSTEM: MGA

MARK ADOPATED: SSM 17778

COORDINATES: E 308 107 827
N 6 241 567 758

CONTOUR INTERVAL: HORIZONTAL ORIGIN
MAJOR 1.0 MINOR 0.5

SCALE: HORZ. 1:500 VERT. 1:100

SHEET 09 OF 17

DRAWING NUMBER: 115804522

REV: 00

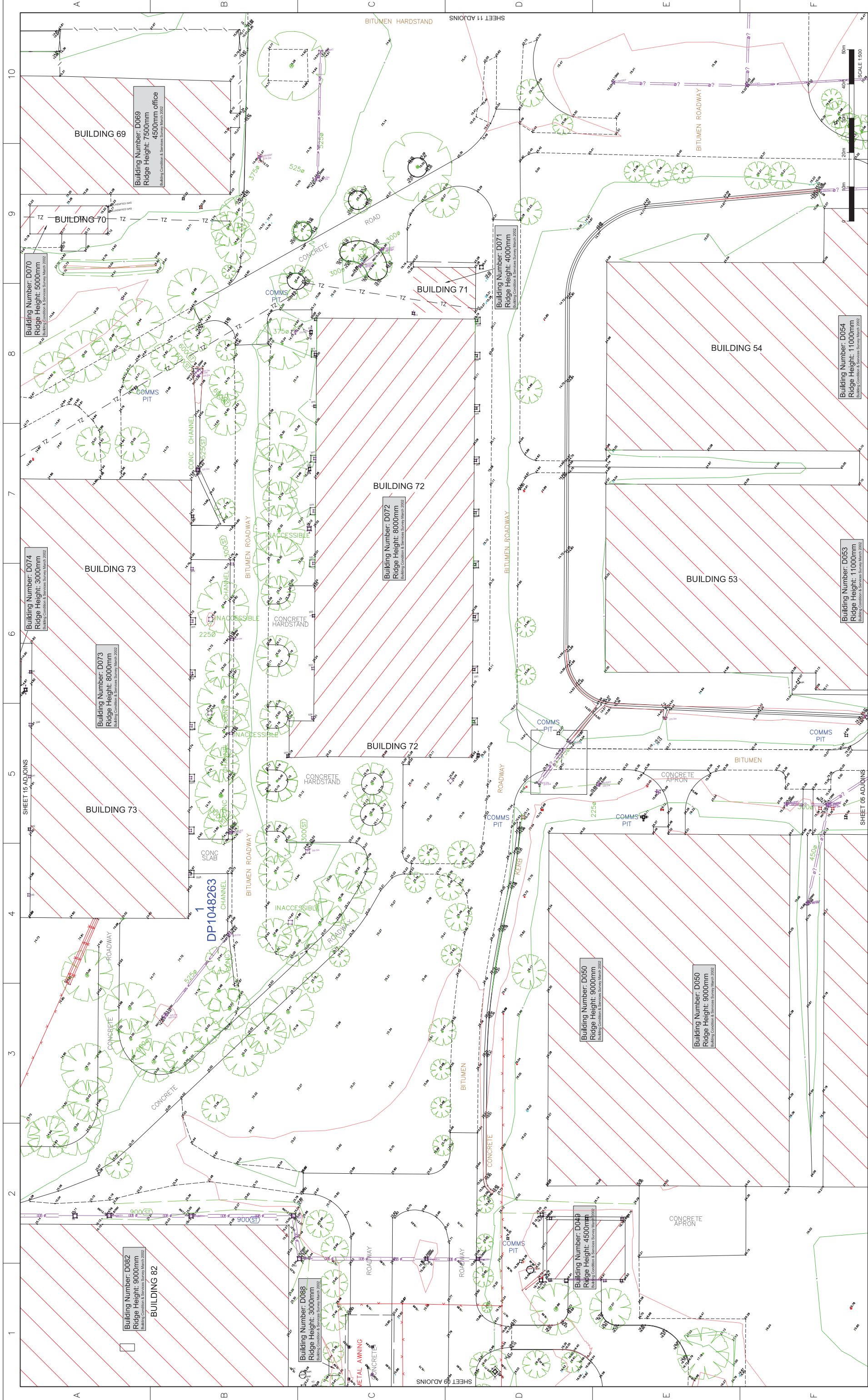

IMPORTANT NOTE: (for TACTICAL PROJECT MANAGEMENT) This drawing is a representation of the proposed design and should not be used for any construction or other purposes. The life boundaries shown hereon were shown by the author at the time of survey and have been determined by plan dimensions only and not by field measurement.

DIAL BEFORE YOU DIG
www.1100.com.au

A services search of the area surveyed above has not been undertaken. Visible services shown hereon have been located where possible by field survey. Prior to any excavation or construction on the site, the location of any underground services or other utilities should be confirmed by a qualified person.

REVISION	DATE	DESCRIPTION	12D REF	APPROVED	PWC
00	23.09.2016	ORIGINAL ISSUE (EXTRACT FROM DRAWING 115804500_17)			

Cardno
Shaping the Future

23-25 Frederick Street
PO Box 175
Rockdale NSW 2216
t: (02) 9597 9700
e: surveys@cardno.com.au w: www.haroforester.com.au

PROJECT: SIMTA - MOOREBANK

CLIENT: TACTICAL PROJECT MANAGEMENT

PROJECT: PLAN SHOWING DETAIL, LEVELS AND CONTOURS

EXTRACT FROM DRAWING 115804500 REV 17 FOR MPE STAGE 2

DRAWN	IT/AH	CHECKED	A.H.	PASSED	A.H.
BW/GOU/HIL/AH					

SCALE: HORZ. 1:500 VERT. MINOR 0.5 MAJOR 1.0

COORD. SYSTEM: MGA

DATUM: AHD

VERTICAL DATUM: RL: 15.212

CONTOUR INTERVAL: HORIZONTAL ORIGIN MARK ADOPTED: SSM 17778

COORDINATES: E 308 107 827 N 6 241 567 758

BM ADOPTED: PM 31039

SHEET	10	OF	17	DRAWING NUMBER	115804522
REV					00

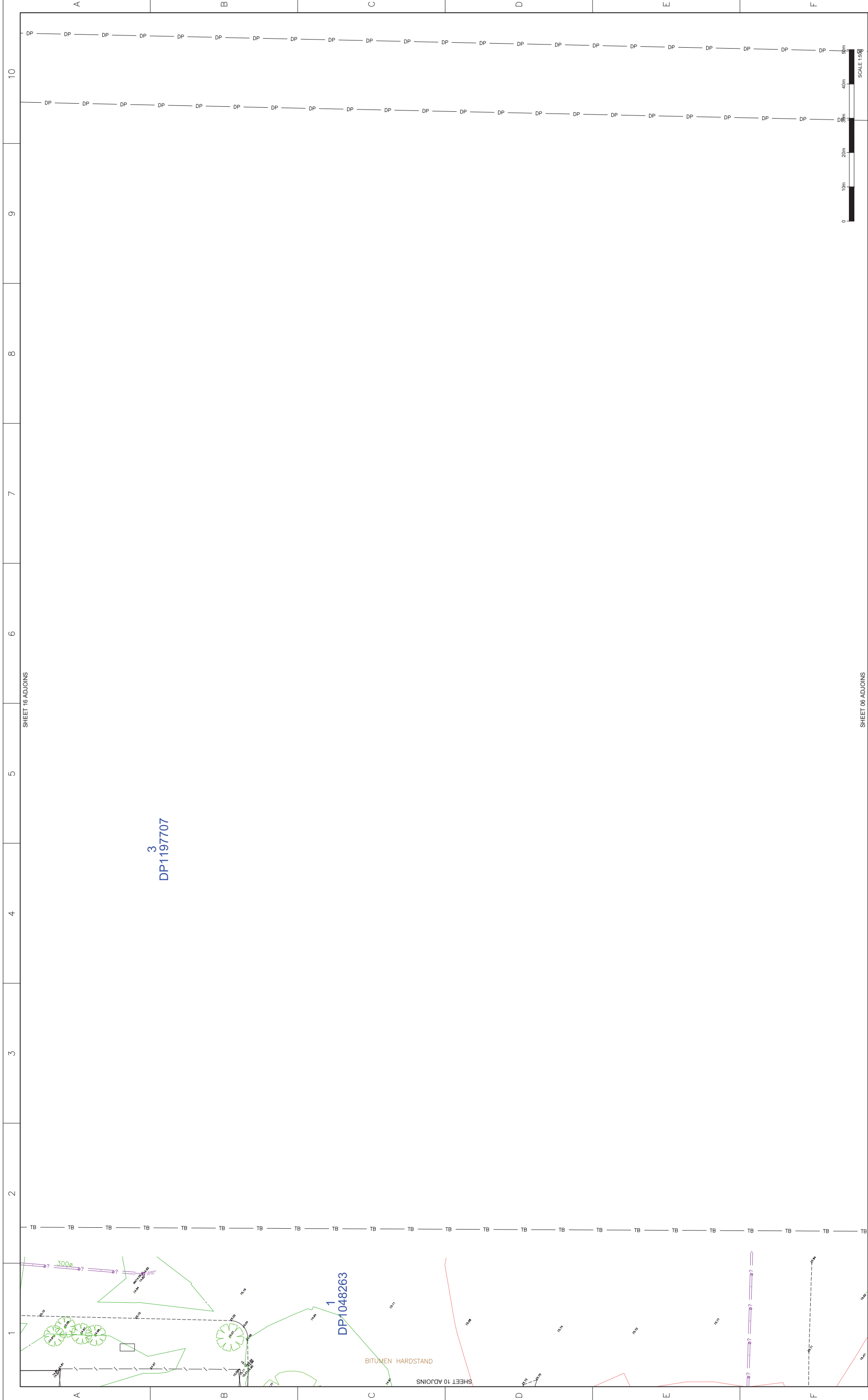

IMPORTANT NOTE: (for TACTICAL PROJECT MANAGEMENT) This drawing is a combination of field survey and existing records for the purposes of designing new constructions on the land and should not be used for any other purpose. The boundaries shown hereon were not marked by the author at the time of survey and have been determined by plan dimensions only and not by field measurement.

DIAL BEFORE YOU DIG www.1100.com.au
 A services search of the area surveyed above has not been undertaken. Visible services shown hereon have been located where possible by field survey. Prior to any demolition, excavation or construction on the site, the location of any visible or possible underground services and detailed locations of all services. This note is an integral part of this plan.

REVISION	DATE	DESCRIPTION	12D REF	APPROVED
00	23.09.2016	ORIGINAL ISSUE (EXTRACT FROM DRAWING 115804500_17)	-	PWC
				APPROVED

SCALE: HORZ. 1:500 VERT. 1:100
 CONTOUR INTERVAL: MAJOR 1.0 MINOR 0.5
 COORD. SYSTEM MGA
 DATUM: AHD
 MARK ADOPTED: SSM 17778
 COORDINATES: E 308 107.627 N 6 241 567.758
 HORIZONTAL ORIGIN
 BM ADOPTED: PM 31039
 RL: 15.212

Cardno *Shaping the Future*
 23-25 Frederick Street
 PO Box 175
 Rockdale NSW 2216
 t: (02) 9597 9700
 e: surveysw@cardno.com.au w: www.haroforester.com.au

PROJECT: SIMTA - MOOREBANK
PLAN SHOWING DETAIL, LEVELS AND CONTOURS
EXTRACT FROM DRAWING 115804500 REV 17 FOR MPE STAGE 2

CLIENT: TACTICAL PROJECT MANAGEMENT

SURVEYED	DRAWN	CHECKED	PASSED
BW/GO/JHL/IAH	IT/IAH	A.H.	A.H.

SHEET 11 OF 17
 DRAWING NUMBER 115804522
 REV 00

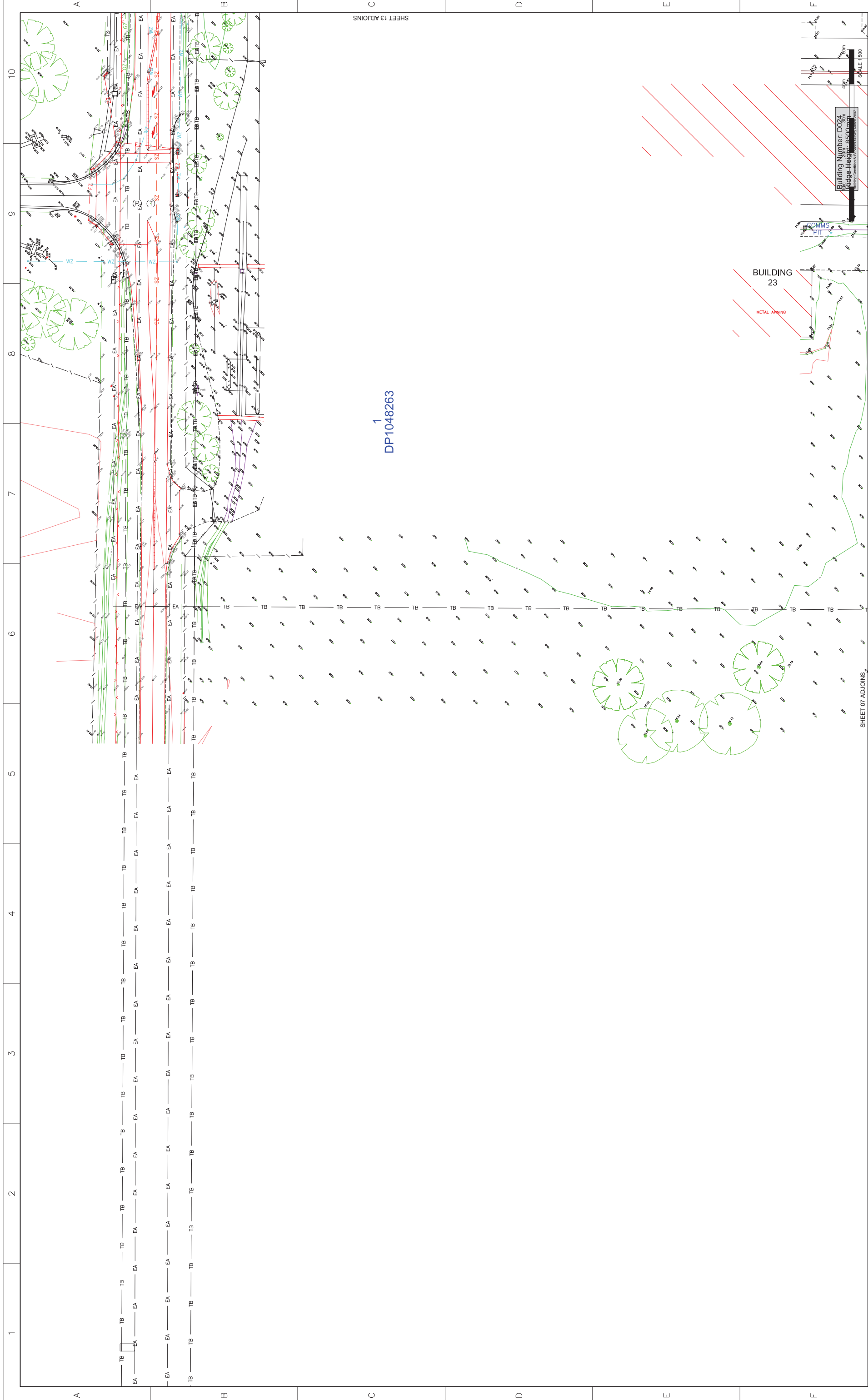

1
DP1048263

IMPORTANT NOTE: This drawing is for TACTICAL PROJECT MANAGEMENT only. It is not to be used for designing new constructions on the land and should not be used for any other purpose. The boundaries shown hereon were not marked by the author at the time of survey and have been determined by plan dimensions only and not by field measurement.

DIAL BEFORE YOU DIG
www.1100.com.au

A services search of the area surveyed above has not been undertaken. Visible services shown hereon have been located where possible by field survey. Prior to any demolition, excavation or construction on the site, the location of all visible and/or possible services and detailed locations of all services. This note is an integral part of this plan.

REVISION	DATE	DESCRIPTION	12D REF	PWC APPROVED
00	23.09.2016	ORIGINAL ISSUE (EXTRACT FROM DRAWING 115804500_17)		

SCALE: HORZ. 1:500 VERT. 1:100		CONTOUR INTERVAL: MAJOR 1.0 MINOR 0.5	
COORD. SYSTEM MGA		HORIZONTAL ORIGIN MARK ADOPTED: SSM 17778	
DATUM: AHD		COORDINATES: E 308 107 827 N 6 241 567 758	
SURVEYED BY: BW/GOJHL/AH		VERTICAL DATUM: RL: 15.212	
DRAWN BY: IT/AH		CHECKED BY: A.H.	
PASSED BY: A.H.		CLIENT: TACTICAL PROJECT MANAGEMENT	

Cardno
Shaping the Future
23-25 Frederick Street
PO Box 175
Rockdale NSW 2216
t: (02) 9597 9700
f: (02) 9589 2146
e: surveys@cardno.com.au w: www.haroforester.com.au

SIMTA - MOOREBANK
PROJECT: SIMTA - MOOREBANK
PLAN SHOWING DETAIL, LEVELS AND CONTOURS
EXTRACT FROM DRAWING 115804500 REV 17 FOR MPE STAGE 2

Building Number: D024
Bridge Height: 8500mm
MINIMUM CLEARANCE OVER ROADWAY

Building 23
METAL RAINING

COMMS PIT

Scale 1:500

Sheet 12 of 17
Drawing Number: 115804522
Rev: 00

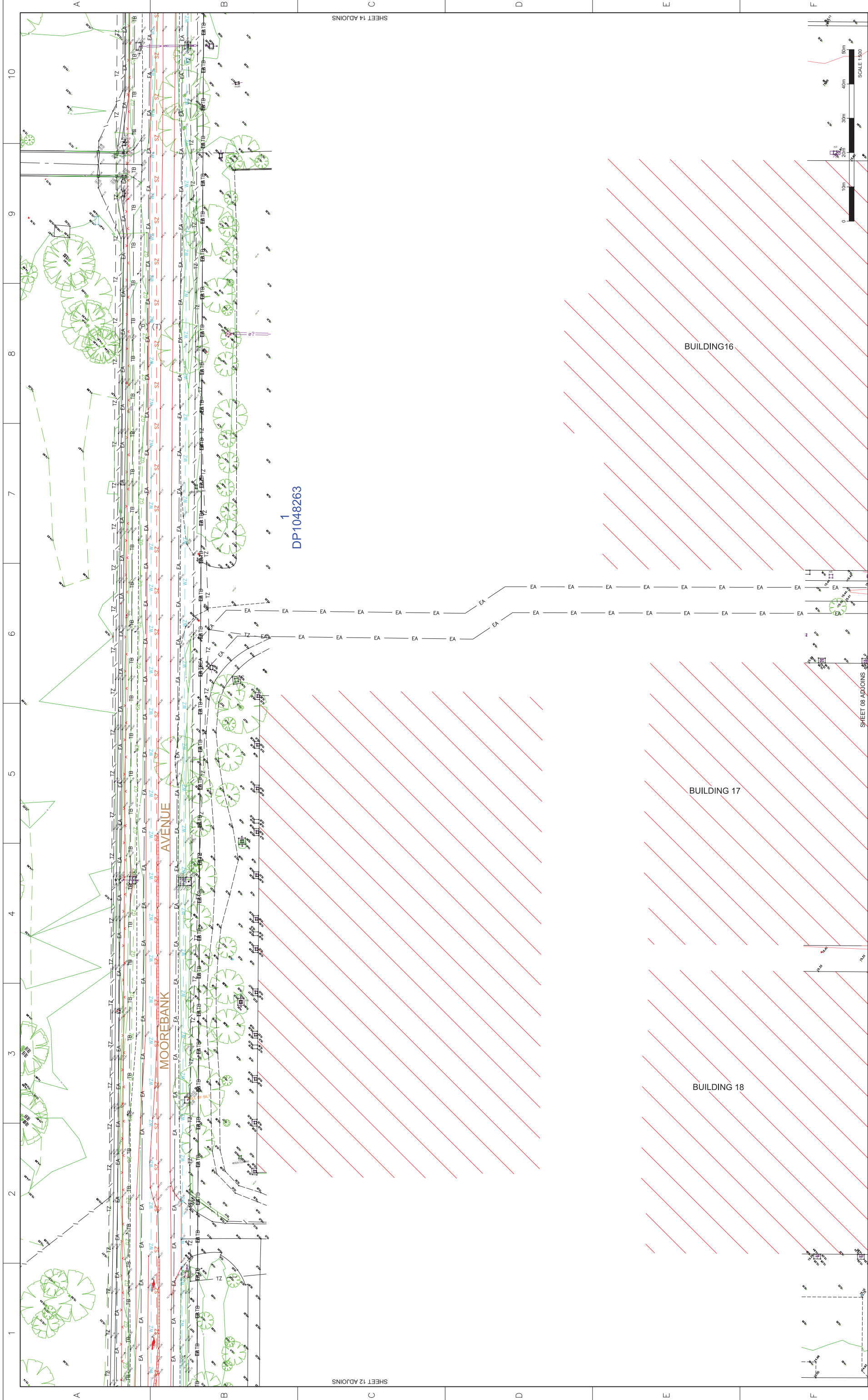

DP1048263

MOOREBANK AVENUE

BUILDING16

BUILDING 17

BUILDING 18

IMPORTANT NOTE:
This drawing is for TACTICAL PROJECT MANAGEMENT from a combination of field survey and existing records for the purpose of designing new constructions on the land and should not be used for any other purpose.
The boundaries shown hereon were not marked by the author at the time of survey and have been determined by plan dimensions only and not by field measurement.

DIAL BEFORE YOU DIG
www.1100.com.au

A services search of the area surveyed above has not been undertaken. Visible services shown hereon have been located where possible by field survey. Prior to any demolition, excavation or construction on the site, the location of any visible or possible underground services and detailed locations of all services. This note is an integral part of this plan.

00	23.09.2016	DATE	ORIGINAL ISSUE (EXTRACT FROM DRAWING 115804500_17)	12D REF	PWC	APPROVED		
REVISION	DATE	DESCRIPTION						
A1		SCALE: HORZ. 1:500 VERT. 1:100 CONTOUR INTERVAL: MAJOR 1.0 MINOR 0.5 COORD. SYSTEM MGA MARK ADOPTED: SSM 17778 COORDINATES: E 308 107 827 N 6 241 567 758 VERTICAL DATUM BM ADOPTED: PM 31039 AHD RL: 15.212		SURVEYED BY: BW/GOU/HJL/H/AH DRAWN BY: IT/AH CHECKED BY: A.H. PASSED BY: A.H.		PROJECT: SIMTA - MOOREBANK PLAN SHOWING DETAIL, LEVELS AND CONTOURS EXTRACT FROM DRAWING 115804500 REV 17 FOR MPE STAGE 2		CLIENT: TACTICAL PROJECT MANAGEMENT
SHEET 13 OF 17		DRAWING NUMBER		115804522		REV 00		

SHEET 12 ADJOINS

SHEET 14 ADJOINS

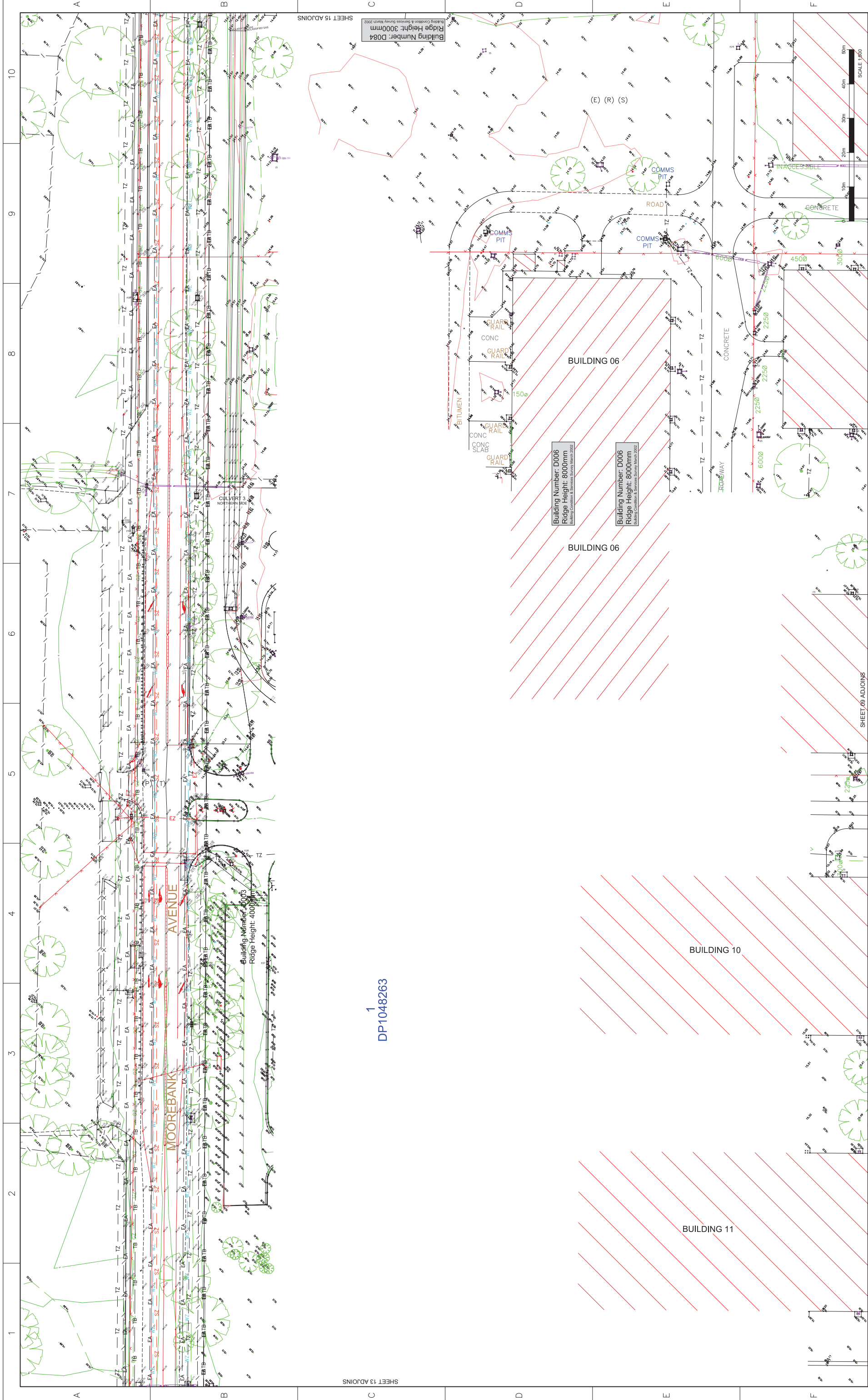

1
DP1048263

SHEET 15 ADJOINS
Building Number: D084
Ridge Height: 3000mm
Subs. from 15/03/2016 Survey March 2002

SHEET 13 ADJOINS

IMPORTANT NOTE: (for TACTICAL PROJECT MANAGEMENT)
This drawing is a summary of the existing records for the purposes of designing new constructions on the land and should not be used for any excavation or construction on the site, the life boundaries shown hereon were not marked by the author at the time of survey and have been determined by plan dimensions only and not by field measurement.
This note is an integral part of this plan.



A services search of the area surveyed above has not been undertaken. Visible services shown hereon have been located where possible by field survey. Prior to any demolition, excavation or construction on the site, the possible location of further underground services and detailed locations of all services. This note is an integral part of this plan.

REVISION	DATE	DESCRIPTION	12D REF	PWC APPROVED
00	23.09.2016	ORIGINAL ISSUE (EXTRACT FROM DRAWING 115804500_17)		

SCALE:	HORZ. 1:500	VERT. MINOR 0.5
CONTOUR INTERVAL:	MAJOR 1.0	
COORD. SYSTEM	MGA	
DATUM:	AHD	
MARK ADOPTED:	SSM 17778	
COORDINATES:	E 308 107 827	
	N 6 241 567 758	
VERTICAL DATUM	BM ADOPTED: PM 31039	
RL:	15.212	

Cardno
Shaping the Future
23-25 Frederick Street
PO Box 175
Rockdale NSW 2216
t: (02) 9597 9700
e: surveys@cardno.com.au w: www.haroforester.com.au

PROJECT: SIMTA - MOOREBANK
PLAN SHOWING DETAIL, LEVELS AND CONTOURS
EXTRACT FROM DRAWING 115804500 REV 17 FOR MPE STAGE 2
CLIENT: TACTICAL PROJECT MANAGEMENT

SHEET	14	OF	17
DRAWING NUMBER	115804522		
REV	00		



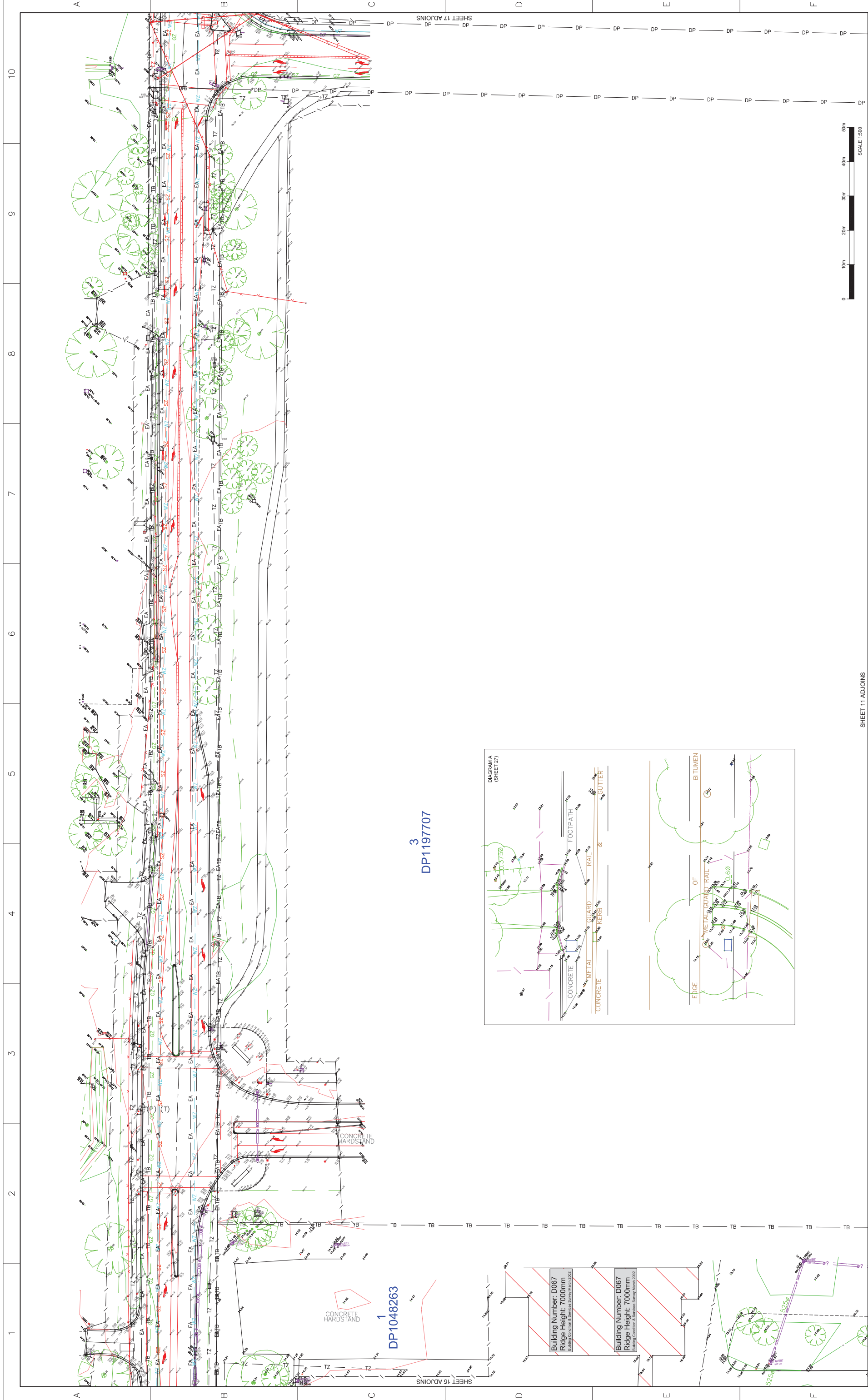

3
DP1197707

1
DP1048263

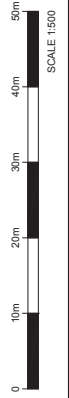
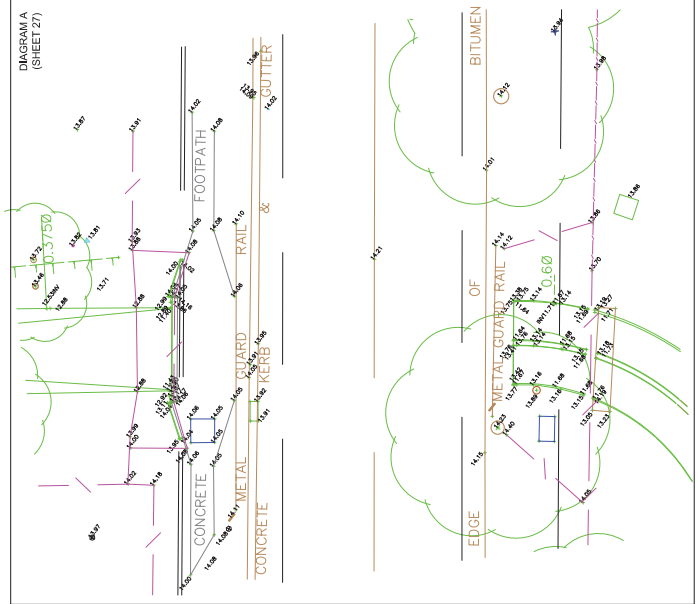

SHEET 11 ADJOINS

		PROJECT: SIMTA - MOOREBANK PLAN SHOWING DETAIL, LEVELS AND CONTOURS EXTRACT FROM DRAWING 115804500 REV 17 FOR MPE STAGE 2		CLIENT: TACTICAL PROJECT MANAGEMENT	
SURVEYED: BW/GOU/HJL/AH DRAWN: IT/AH CHECKED: A.H. PASSED: A.H.		SCALE: HORZ. 1:500 VERT. MINOR 0.5 MAJOR 1.0		SHEET 16 OF 17 DRAWING NUMBER 115804522 REV 00	
COORD. SYSTEM: MGA DATUM: AHD BM ADOPTED: PM 31039 RL: 15.212		CONTOUR INTERVAL: MINOR 0.5 HORIZONTAL ORIGIN: MARK ADOPTED: SSM 17778 COORDINATES: E 308 107.827 N 6 241 567.758 VERTICAL DATUM: BM ADOPTED: PM 31039 RL: 15.212		SHEET 17 ADJOINS	
IMPORTANT NOTE: This drawing is for TACTICAL PROJECT MANAGEMENT from a combination of field survey and existing records for the purpose of design and should not be used for any new construction. The life boundaries shown hereon were not marked by the author at the time of survey and have been determined by field dimensions only and not by field measurement.		DIAL BEFORE YOU DIG www.1100.com.au A services search of the area surveyed above has not been undertaken. Visible services shown hereon have been located where possible by field survey. Prior to any demolition, excavation or construction on the site, the possible location of further underground services and detailed locations of all services. This note is an integral part of this plan.		REVISION: 00 DATE: 23.09.2016 ORIGINAL ISSUE (EXTRACT FROM DRAWING 115804500_17) PWC APPROVED 12D REF	

This page has been left blank intentionally